

Compliance

- ICAO Annex 14 ,
- FAA AC 150/5345-46,
- EB 67 D
- IEC61827
- EASA CS-ADR-DSN.M.710 & 715
- STANAG 3316
- CAAC GB-T 7256-2005
- AENA DIN/OSEYN/PPT/018-02/09

Uses

- The TCLMS-08-LED-E is a Taxiway Centreline light suitable for applications on taxiway and apron system operating in Cat I to III conditions. This includes applications for Stop bars, Clearance bars and Intermediate Holding Positions.

Features

- **8"** outer diameter
- **6 mm** height above surface
- **Dust and Water tight**
- **Useful Lamp Life (LED)** > 50.000h
- **Nominal Current:** 6.6A (2.2A available upon request)
- **Power consumption** (at 6.6A): 15W per side
- **Power Factor** 0.95 at nominal current
- **Temperature:** - 55°C to + 55°C
- **Advanced Power Adaptor** electronics with Integrated 5 steps Active Fail Open System
- **Self Rearming** Fail Open System no additional intervention required after repair of a failure.
- **Fully dimmable** as per EB67D
- **Built-in surge protection**
- **Compatible** with existing AGL circuits
- **Efficient control of the operating temperature** of the LEDs increasing life expectancy and avoiding any colour shift.
- **Upper surface without sharp edges**, reducing the risk of damage to aircraft tires

Finish

- Outer Surface with wear & corrosion resistant treatment.
- High-precision machining ensuring overall precision and excellent quality.
- Stainless steel hardware.

Electrical Supply

6.6 A, through a 150 W isolating transformer.

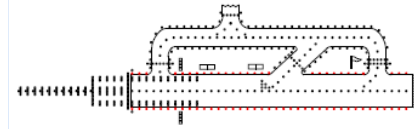

Inset
Taxiway Centreline
Light

TCLMS-08-LED-E

Airsafe

Components

1. Upper Cover
2. Prism Seal Cartridge
3. Prism
4. Prism Shim
5. Prism Pressure Plate
6. LED Illuminant
7. Cooling Panel
8. Sealing Washer
9. Side Sealing Strip
10. LED Inner Cap Module

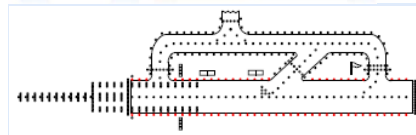
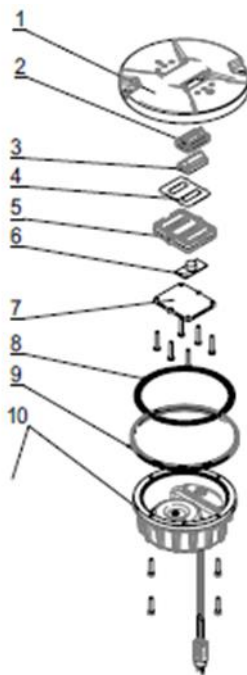

Inset
Taxiway Centreline
Light

TCLMS-08-LED-L

Airsafe

Photometric Characteristics

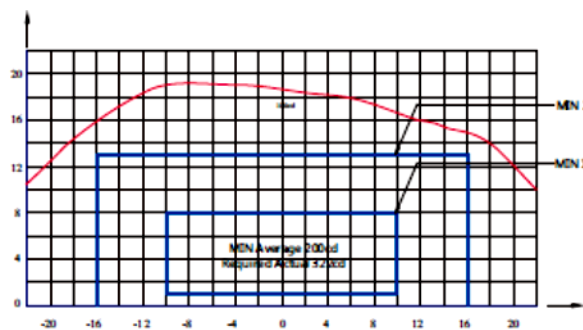

Centerline light
ICAO Fig A2-12 & FAA L-852C , Green

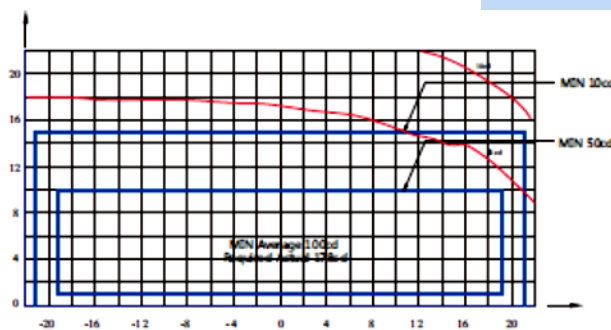

Centerline light
ICAO Fig A2-14 & FAA L-852C , Green

Applications		Angle of Main Light Beam		Colour	Average Intensity Required cd	Average Intensity Actual cd
		Horizontal	Vertical			
Taxiway Centerline Straight	FAA L-852C ICAO Fig A2-13	± 3.5°	1 to 8°	Green	200	432
	Yellow			200	466	
	FAA L-852C ICAO Fig A2-12	± 10°	1 to 8°	Green	200	322
				Yellow	200	385
Taxiway Centerline Straight Curve	FAA L-852C ICAO Fig A2-14	± 3.5° To 35°	1 to 10°	Green	100	178
	Yellow			100	203	
	FAA L-852D	± 30°	1 to 10°	Green	100	125
				Yellow	100	151

Grounding

The light is equipped with a grounding point as shown on the figure.

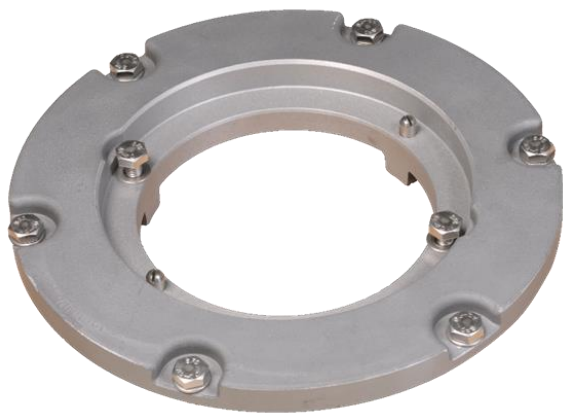
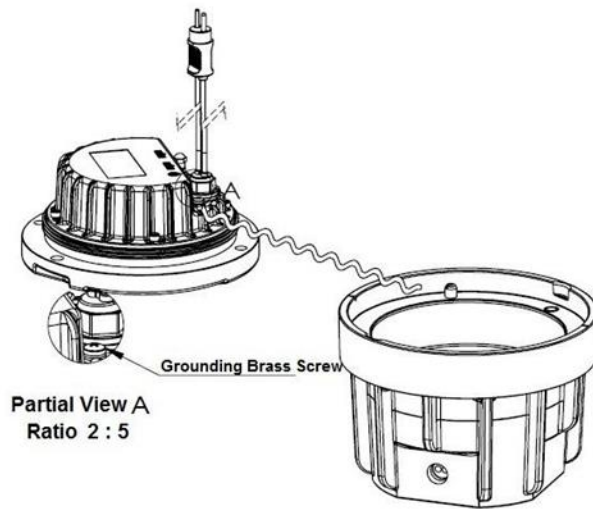

Adaptor Ring

An adaptor ring in forged aluminium is available for mounting of the light on a 12" base

Lifting Handle

A lifting handle in aluminium has been designed for easy installation and removing of the light on its base



Ordering Information

TCLMS - 08 - X - LED - XX - XP - E

TCLMS-08

Taxiway Centre Line Light 6 mm protrusion

Type

S = Straight

C = Curved

Beam Colour

G = Green

Y = Yellow

R = Red

B = Blank

Input

1P = One Plug

P = Two Plugs

Version

E = Europe

