

Compliance

FAA: AC 150/5345-46

ICAO: Annex 14 Para. 5.3.18, for use as taxiway edge light

EASA: CS ADR-DSN.Book 1

IEC: 61827

NATO: STANAG 3316

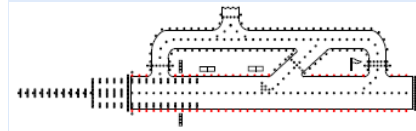

Inset
Taxiway Edge Light

TOEL-08-LED

Airsafe

Uses

- The TOEL-08-LED is a Taxiway light suitable for applications on taxiway and apron edge

Features

- **8"** outer diameter
- **Dust and Water** tight
- **Useful Lamp Life** (LED) > 50.000h
- **Nominal Current:** 6.6A
- **Power consumption** (at 6.6A): 9W
- **Power Factor** 0.95 at nominal current
- **Temperature:** - 55°C to + 55°C
- **Advanced Power Adaptor** electronic
- **Optional** 5 steps Fail Open System
- **Fully dimmable** as per EB67D
- **Built-in surge protection**
- **Compatible** with existing AGL circuits
- **Efficient control of the operating temperature** of the LEDs increasing life expectancy and avoiding any colour shift.
- **Upper surface without sharp edges**, reducing the risk of damage to aircraft tires

Finish

- Outer Surface with wear & corrosion resistant treatment.
- High-precision machining ensuring overall precision and excellent quality.
- Stainless steel hardware.

Electrical Supply

6.6 A, through a 150 W isolating transformer.

Components

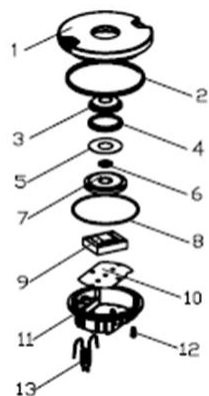

- 1. Upper cover
- 2. Upper sealing ring
- 3. Omnidirectional prism
- 4. Prism seal
- 5. Prism gasket
- 6. LED lamp
- 7. Prism retainer
- 8. Upper sealing ring
- 9. Isolation transformer
- 10. Driving circuit
- 11. Inner cover
- 12. Valve core
- 13. Style 6 plug

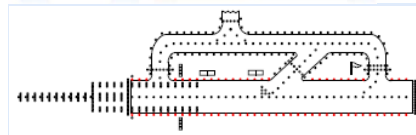

Inset
Taxiway Edge Light

TOEL-08-LED

Airsafe

Photometric Characteristics

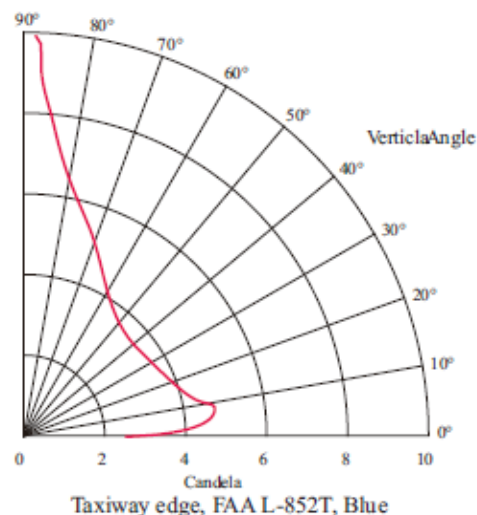

Applications		Color	Vertical Angle of Main Light Beam	Intensity Required (cd)	Actual Intensity (cd)
Taxiway Edge	FAA L-852T	Blue	1 to 6°	2	2 to 5
			6 to 75°	0.2	1 to 5