



COMPLIANCE

- ICAO Annex.14 Vol.1
- FAA AC 150/5345-46
- IEC-TS 61827
- EASA: CS-ADR-DSN
- STANAG 3316
- AENA PPT-010_03-12



BOARDING TIME

BOARDING PASS

NAME OF PASSANGER

FROM:

TO:

DATE FLIGHT
 GAES2020

GATE SEAT
23 21B

GATE CLOSES 30 MINUTES BEFORE DEPARTURE

BOARDING PASS

Uses

In-pavement approach centerline / crossbar light for straight direction for airports tramos rectos para aeropuertos CAT I, II & III, according to ICAO Figure A2-1.

Features

- 12" external diameter.
- Body casting manufactured on forged aluminum, with high strength and optimum mechanical performance.
- A patented prism design to guarantee an excellent optical performance and ensures high resistance to temperature and pressure changes.
- The upper cover is designed with a flat surface at the light beam exits to prevent the accumulation of water and ensure high luminous efficiency.
- Bulb fixing design based on suspension mounting to effectively prolong bulb's lifetime
- Use of standard halogen reflector lamps.
- No adjustments required after lamp or another optical component replacement.
- High precision machining of parts and components to guarantee the quality and dimensions of each piece.
- Stainless steel hardware to grant the waterproof and corrosion resistance.
- Multi-slip waterproof gasket to ensure an appropriate seal with the base.
- Interchangeable components, usable in all lights of the range.

Specifications

- Power: 2.8A ~ 6.6 A.
- Lamp: 3x105W /6.6A halogen lamp with reflector
- Lamp average life: More than 1.500h at maximum brightness and more than 3.000h in a normal operation conditions.
- Color: White
- Index Protection: IP68.

APP-12 | In-pavement approach centerline / crossbar light - Airsafe

Order Code

APP-12 - X - 315 - C

Type *APP-12 = In-pavement approach centerline / crossbar light (12")*

Beam direction *S = Straight
L = Left toe-in
R = Right toe-in*

Power *315 = 3 x 105W*

Beam color *C = Clear (White)*

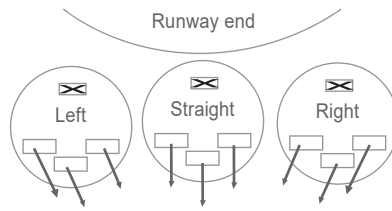

Installation

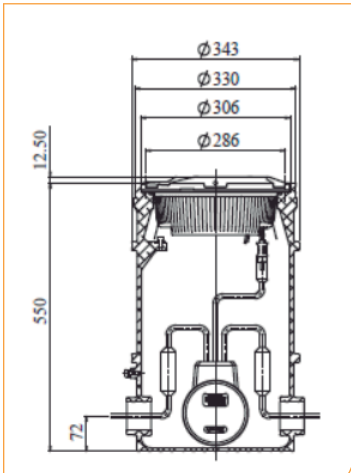

Figure 1
On 12" deep base

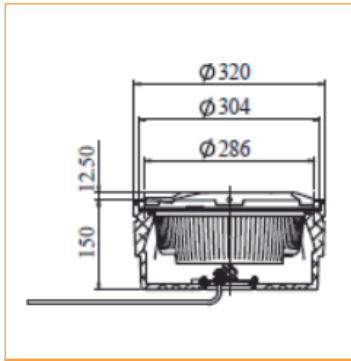
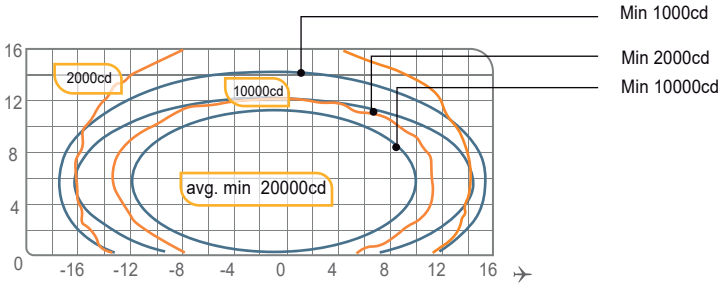

Figure 2
On 12" shallow base

Photometry



APP-12, ICAO Fig. A2-1, White

Application		Main Beam		Color	Required min avg. cd.	Actual avg. cd.
		H	V			
APP-12	ICAO Fig A2-1	±10°	0° a 11°	White	2.000	21.959
		±10°	0,5° a 11,5°	White	2.000	21.160
		±10°	1,5° a 12,5°	White	2.000	23.579
		±10°	2,5° a 13,5°	White	2.000	21.087



Structure

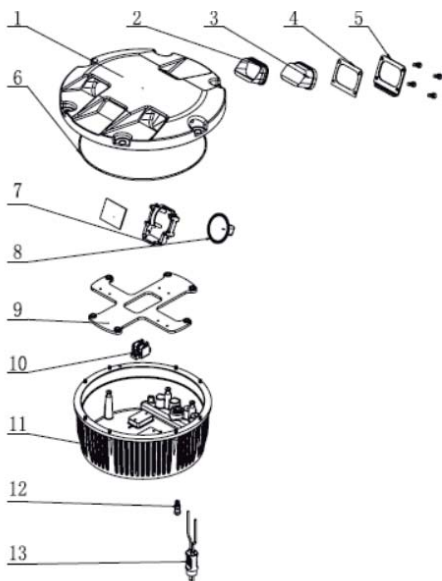

- 1 Upper cover
- 2 Prism gasket sleeve
- 3 Prism
- 4 Prism gasket
- 5 Prism pressing bracket
- 6 Light body gasket
- 7 Lampholder
- 8 Lamp
- 9 Mounting plate
- 10 Terminal block
- 11 Inner cover
- 12 Valve
- 13 Plug

Spare Parts

N°	Order No.	Description
2	43107	Prism gasket sleeve
3	31141	Prism
4	43307	Prism gasket
5	43208	Prism pressing bucket
6	41135	Light body gasket
7	942133	Lamp holder
8	L64339	Lamp
10	941201	Terminal block
12	941801	Valve
13	HT70603	Plug

Accessories

N°	Order No.	Description
1	SB-12	12" shallow base assy
2	DB-12	12" deep base assy
3	41115	12" base o-ring gasket
4	51121	12" lamp holder
5	ITF-300-066	300W Isolation transformer
6	REC7	Secondary cable receptable style 7



Weight and Dimensions

	Base	12" shallow base
Packaging size	330x330x150mm ³	340x340x190mm ³
Weight	7,3 kg	11,8 kg