

**PAPI-300 | Precision Approach Path Indicator - Airsafe**



### COMPLIANCE:

- ICAO Annex. 14, Vol.I
- FAA AC 150/5345-28
- EASA: CS-ADR-DSN
- STANAG 3316
- AENA PPT-020\_04-12



BOARDING TIME

#### BOARDING PASS

NAME OF PASSANGER

FROM:

TO:

DATE: FLIGHT GAES2020

GATE 23 SEAT 21B

GATE CLOSSES 30 MINUTES BEFORE DEPARTURE

BOARDING PASS

## Uses

Precision Approach Path Indicator for airports CAT I, II & III according ICAO annex 14 Vol.I. Figure A2-23.

Features

- Intelligent electrical control system force PAPI system turn off automatically when the failures of FAA and ICAO happen, and turn on the control system alarm due to the CCR under voltage.
- LED digital display on each fixture, display the elevation angle in real-time, resolution of  $\pm 0.01$  (0.6 cent), the range of angel over 9.99 of vertical.
- One step operate unit control box and display usual information remind on the panel, simple operation and easy to understand.
- Self checking system ensures the reliable and safety of system.
- The optional communication module allows monitoring the status equipment from the general visual aids control system.
- The system is supporting on three legs that allow adjustment of height an easy and reliable.
- Unique system design of dual-lens structure and three individual light ways, accurately lamps and filters positioning device, no need to correct position again when change the lamps and filters.
- Aluminum alloy material for light body, special processing on surface, all fasteners use high quality stainless steel material; make fixture ethereal, strong and good anti-corrosion property.
- Smaller volume for the light body, smaller wind-facing area and wind load reach 161 km/h.



## PAPI-300 | Precision Approach Path Indicator - Airsafe

### Photometry

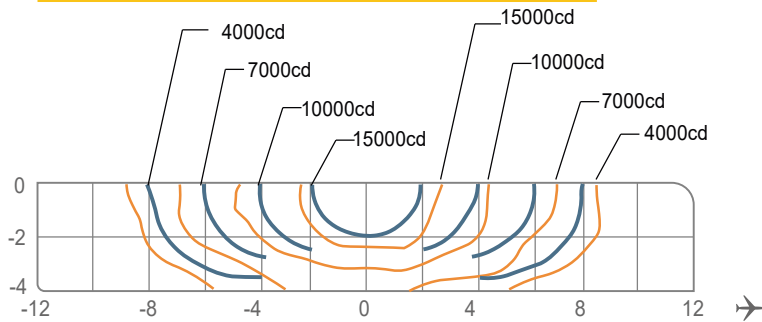

Precision Approach Path Indicator, ICAO Fig A2-23, White/Red

Horizontal Angle	Vertical Angle	Main Beam Light Intensity	Red (cd)	Clear (cd)
$\pm 2^\circ$	$\pm 2^\circ$	Standard required	15.000	2 to 6.5 times of the red intensity
		Actual light intensity	>18.400	>90.000

### Instructions

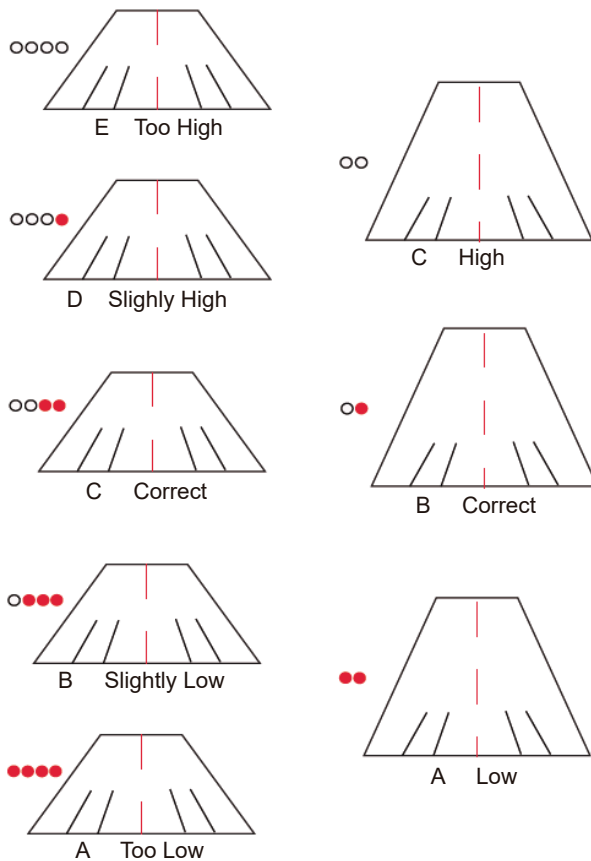

**PAPI-300 | Precision Approach Path Indicator - Airsafe**



**Structure**

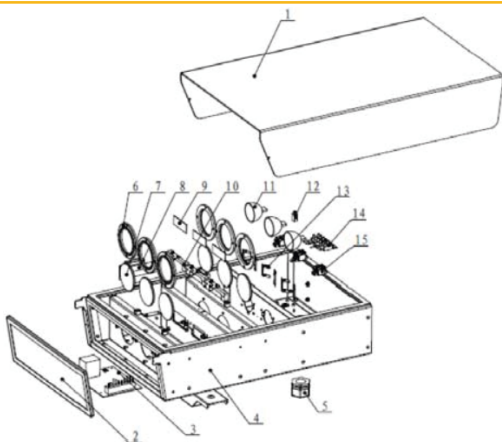

- 1 Front glass pressure ring
- 2 Front glass gasket
- 3 Control board
- 4 Body
- 5 Flexible duct for connect
- 6 Pressing bracket gasket
- 7 Lens
- 8 Gasket
- 9 Filter
- 10 Filter retainer assy
- 11 Prefocused lamp
- 12 Terminal block
- 13 Closing spring (90°)
- 14 Wiring duct (6 ducts)
- 15 Terminal

**Accessories**

N°	Order No.	Description
1	61160	Front glass pressure ring
2	61123	Front glass gasket
3	61199	Control board
4	61130	Body PAPI
5	NBG-08G	Flexible duct for connect
6	61126	Pressing bracket gasket
7	61185	Lens
8	61147	Gasket
9	61175	Filter
10	61170	Filter retainer assy
11	64339A	Prefocused lamp
12	61148	Terminal block
13	42207	Closing Spring
14		Wiring duct
15	91201	Terminal



**Weight and Dimensions**

• Packaging size	860 × 570 × 290 mm <sup>3</sup>
• Weight	14,80 kg