

**RCLS-08-LED**

**In-pavement LED runway centerline light - Airsafe**



**COMPLIANCE:**

- ICAO Annex.14 Vol.1
- FAA AC 150/5345-46
- IEC-TS 61827
- EASA: CS-ADR-DSN
- STANAG 3316
- AENA PPT-013\_03-12



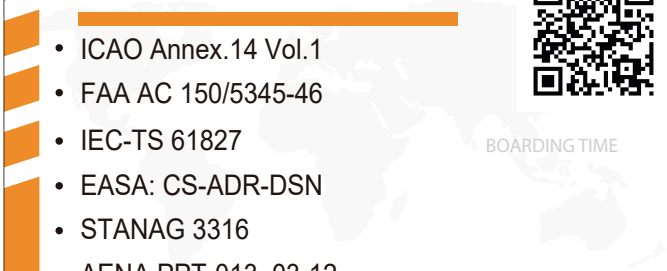

**BOARDING PASS**

NAME OF PASSANGER

FROM:

TO:

DATE                      FLIGHT  
                                    GAES2020

GATE                      SEAT  
23                          21B

GATE CLOSSES 30 MINUTES BEFORE DEPARTURE

BOARDING PASS

**Uses**

In-pavement LED runway centerline lights for airports CAT I, II y III, according to ICAO, Figures A2-6 & A2-7.

**Features**

- 8" external diameter, with upper and lower cover manufactured on high strength forged aluminum, and only 6mm of profile over pavement.
- Stainless steel hardware.
- Uni-directional and bi-directional configuration.
- Surface treatment to prevent the wear and increase the corrosion resistance, which makes it especially resistant to dust and water.
- Smooth surface without sharpened edges to avoid damages at the aircraft tyres.
- Regulation according to FAA EB67E equivalent to a halogen lamp.
- Integrated surge protection.
- Efficient control of LEDs operating temperature, increasing the light life and avoid color change.
- High features optical design.
- Compatible with existing circuits of visual aids.

**Specifications**

- Power: 2.8A ~ 6.6A, according to FAA EB67D.
- Average life: minimum 60.000h at maximum brightness and 100.000h in a normal operating conditions.
- Colors: Red and White
- Consumption: 24VA (bi-direccional) - 18VA (uni-direccional) ; FP >0,95
- Index Protection: IP68.

**RCLS-08-LED** | In-pavement LED runway centerline light - Airsafe

**Order Code**

RCLS-08 - LED - XX - XX - X

Type *RCLS-08 = 8" runway centerline light*

Light source *LED*

Beam color  
*CC = Window 1: white / Window 2: white*  
*CR = Window 1: white / Window 2: red*  
*CB = Window 1: white / Window 2: in blank*  
*RB = Window 1: red / Window 2: in blank*

Plug  
*1P = 1 plug*  
*2P = 2 plugs*

Optional functions  
*M = Single lamp fault detection function*  
*A = Artic kit*



**Installation**

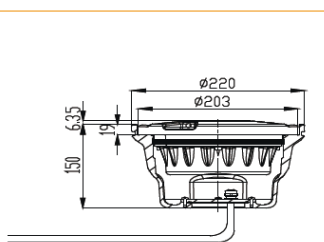

**Figure 1**  
On 8" shallow base

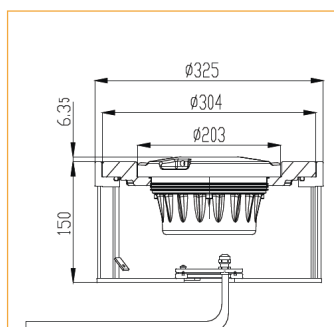

**Figure 2**  
On 12" shallow base  
with 12" - 8" adapter ring

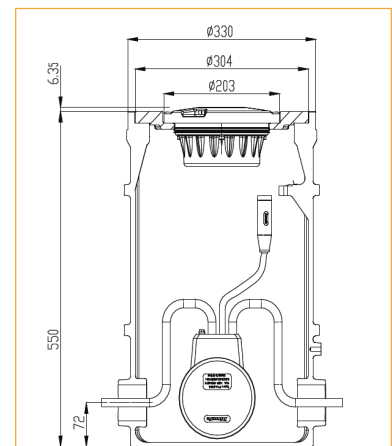

**Figure 3**  
On 12" deep base with  
12" - 8" adapter ring

## RCLS-08-LED | In-pavement LED runway centerline light - Airsafe

### Photometry

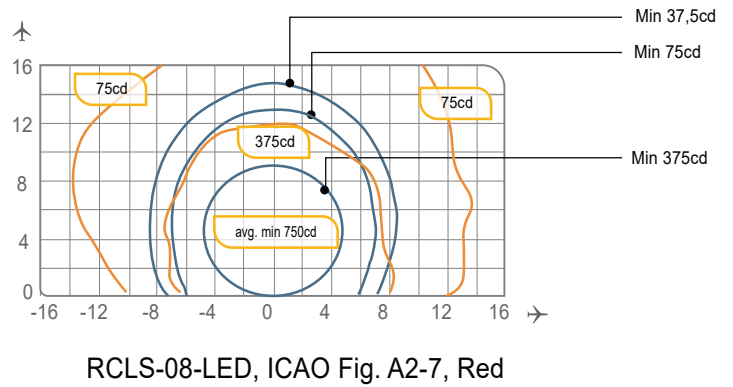
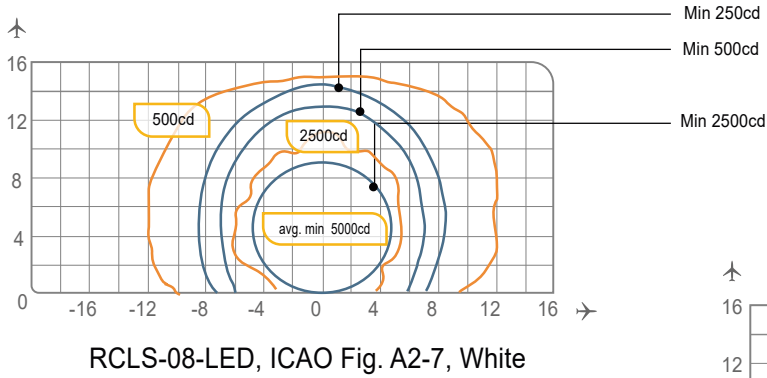

Application		Main beam		Color	Required min. avg. cd.	Actual avg. cd.
		H	V			
RCLS-08-LED	ICAO Fig A2-7	±5°	0° a 9°	White	5.000	7.184
			0,2° a 9°	Red	750	1.598
	ICAO Fig A2-6	±5°	0° a 7°	White	5.000	7.381
			Red	750	1.567	



### Structure

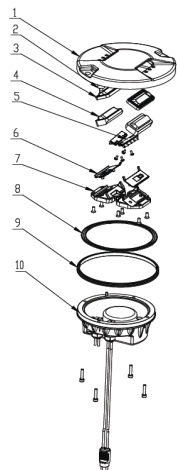

- 1 Upper cover
- 2 Thermal switch
- 3 Prism gasket sleeve
- 4 Prism
- 5 LED lamp assy
- 6 Prism gasket
- 7 Prism pressing bracket
- 8 Light body gasket
- 9 Lighting fixture gasket
- 10 Inner cover assy

## RCLS-08-LED | In-pavement LED runway centerline light - Airsafe

### Spare Parts

N°	Order No.	Description
3	43117	Prism gasket sleeve
4	31158	Prism
5	932053-RCLS-C	LED lamp assy RCLS-C
	932053-RCLS-C	LED lamp assy ENDS-R
6	43316	Prism gasket
7	43241	Prism pressing bracket
8	41141	Light body gasket
9	41107	Light fixture gasket

### Accessories

N°	Order No.	Description
1	SB-08	8" shallow base
2	SB-12	12" shallow base
3	DB-12	12" deep base
4	AR-12/08	12" - 8" adaptador ring
5	951101	8" lamp handle
6	ITF-065-066	65W isolation transformer
7	ITF-150-066	150W isolation transformer
8	REC7	Secondary cable receptacle style 7



### Weight and Dimensions

	Base	8" shallow base
<b>Packaging size</b>	210x210x130mm <sup>3</sup>	240x240x180mm <sup>3</sup>
<b>Weight</b>	3,5 kg	6,5 kg