

**EBL-RE-II | Elevated runway edge light - Airsafe**



### COMPLIANCE:

- ICAO Annex.14, Vol I.
- FAA AC 150/5345-46
- IEC-TS 61827
- EASA CS-ADR-DSN.
- STANAG 3316
- AENA PPT-016\_06-12

BOARDING TIME

#### BOARDING PASS

NAME OF PASSANGER

FROM:

TO:

DATE                      FLIGHT  
                                 GAES2020

GATE                      SEAT  
23                          21B

GATE CLOSSES 30 MINUTES BEFORE DEPARTURE
GAES 454843121451100

GOMINTEC
BOARDING PASS
GOMINTEC

## ✈ Uses

Elevated runway edge light for airports CAT I, II & III, according to ICAO Fig A2-9 & A2-10.

## ✈ Features

- Compact and lightweight structure with reduced wind exposed surface.
- Exclusive optical design based on glass diffuser with inner refractive prisms to avoid dirt deposit.
- Reduced height to minimize the jet blast impact.
- Robust body built on high strength aluminum alloy, anti-corrosion treatment and excellent thermal dissipation.
- Stainless steel hardware to grant the waterproof and corrosion resistance.
- Glass diffuser fixed to the main body through retaining ring and waterproof gland without additional sealants.
- International standard PK30D prefocus bulb.
- No adjustments required after lamp or another optical component replacement.
- No tools required to access to the lamp housing, to provide an easy maintenance.
- Interchangeable components, usable in all types of elevated uni-directional lights.

## ✈ Specifications

- Power: 2.8A ~ 6.6A.
- Prefocused halogen lamp: 1x150W / 6.6A Pk30d.
- Lamp average life: More than 1.500h at maximum brightness and more than 3.000h in a normal operation conditions.
- Colors: White, Yellow and Red.
- Index Protection: IP65

**Order Code**

EBL-RE-II - 150 - XX

Type *EBL-RE-II =Elevated runway edge light (type II)*

Power *150 = 150W*

Beam color

*YC = Window 1: yellow | Window 2: white*  
*CY = Window 1: white | Window 2: yellow*  
*CC = Window 1: white | Window 2: white*  
*CR = Window 1: white | Window 2: red*  
*RC = Window 1: red | Window 2: white*

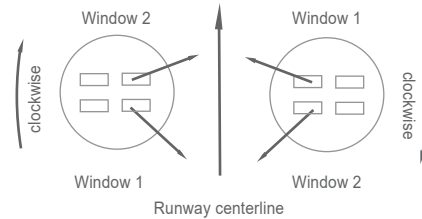

**Installation**

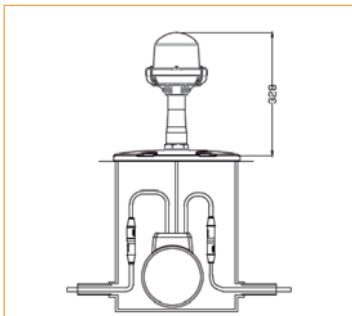

**Figure 1**  
*On 12" deep base*

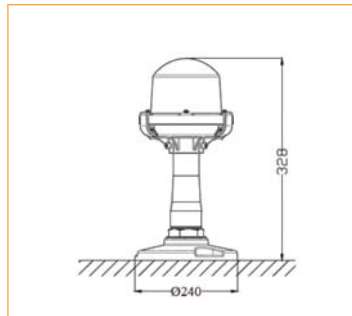

**Figure 2**  
*Flange direct mount*

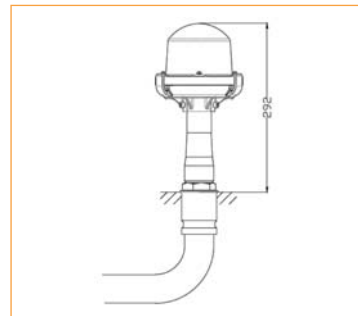

**Figure 3**  
*Embedded pipe mount*

## EBL-RE-II | Elevated runway edge light - Airsafe

### Photometry

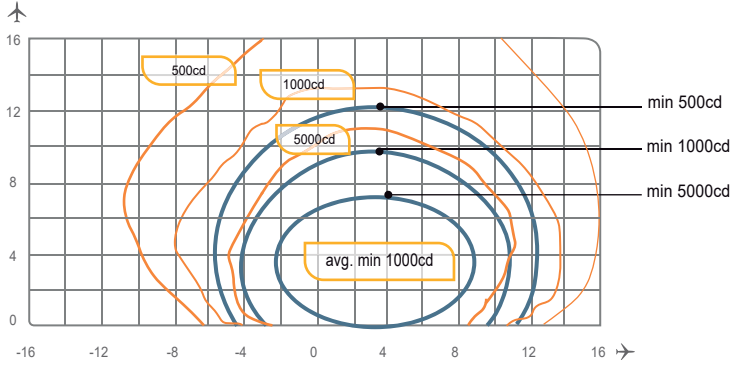

EBL-RE-II, ICAO Fig A2-9, White

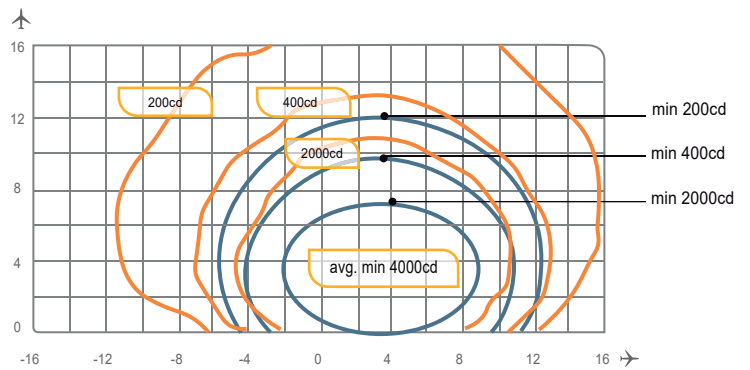

EBL-RE-II, ICAO Fig A2-9, Yellow

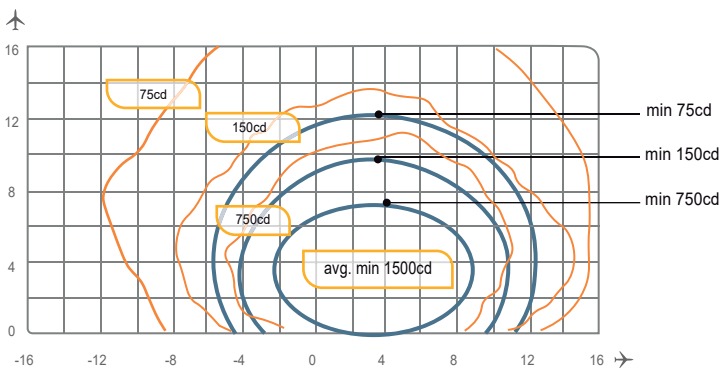

EBL-RE-II, ICAO Fig A2-9, Red

Application		Main beam		Color	Required min.avg. cd.	Actual avg. cd.
		H	V			
EBL-RE-II	ICAO Fig. A2-9 FAA L-862 (Toe-in 3,5°)	± 5,5°	0 a 7°	White	10.000	11.191
		± 5,5°	0 a 7°	Yellow	4.000 / 5.000	6.780
		± 5,5°	0 a 7°	Red	1.500 / 2.000	2.233
	ICAO Fig. A2-10 (Toe-in 4,5°)	± 6,5°	0 a 7°	White	10.000	10.408
		± 6,5°	0 a 7°	Yellow	4.000	6.230
		± 6,5°	0 a 7°	Red	1.500	2.012

EBL-RE-II | Elevated runway edge light - Airsafe



**Structure**

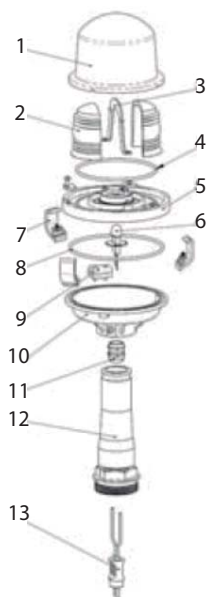

- 1 Optical cover
- 2 Achromatic lens
- 3 Lens baffle
- 4 Optical cover gasket
- 5 Optical cover holder
- 6 Lamp
- 7 Hasp
- 8 Light body gasket
- 9 Lamp socket
- 10 Light body
- 11 Waterproof gland
- 12 Frangible pole
- 13 Plug

**Spare Parts**

N°	Order No.	Description
1	34104	Optical cover
2	34203-C	Achromatic lens (clear)
	34203-Y	Achromatic lens (yellow)
	34203-R	Achromatic lens (red)
3	46604	Lens baffle
4	41146	Optical cover gasket
6	L64361	Prefocus halogen lamp 150W Pk30D
7	645519	Hasp
8	41147	Light body gasket
9	41221	Lamp socket
10	241B1-01	Light body base
11	48401	Waterproof gland
12	24211	Frangible pole
13	HT 70603	Plug

**EBL-RE-II | Elevated runway edge light - Airsafe**

**Accessories**

N°	Order No.	Description
1	276A1	Flange 240mm
2	27683	Flange 304mm (FAA standard)
3	54101	Hex wrench for frangible of elevated lights
4	954211	Calibrator assy
5	70703	Secondary cable receptacle style 7
6	ITF-045-066	45W isolations transformer
7	TJB-12	Isolation transformer box



**Weight and Dimensions**

• <b>Packaging size</b>	350 x 285 x 365 mm <sup>3</sup>
• <b>Weight</b>	8,75 kg