

THR-12 | In-pavement runway threshold light - Airsafe



COMPLIANCE:

- ICAO Annex.14 Vol.1
- FAA AC 150/5345-46
- IEC-TS 61827
- EASA: CS-ADR-DSN
- STANAG 3316
- AENA PPT-010_03-12



BOARDING TIME

BOARDING PASS

NAME OF PASSANGER

FROM:

TO:

DATE

FLIGHT
GAES2020

GATE

23

SEAT

21B

GATE CLOSSES 30 MINUTES BEFORE DEPARTURE

GOMINTEC

BOARDING PASS

GOMINTEC

Uses

In-pavement runway threshold light for airports CAT I, II & III, according to ICAO, Figure A2-3.

Features

- 12" external diameter.
- Body casting manufactured on forged aluminum, with high strength and optimum mechanical performance.
- A patented prism design to guarantee an excellent optical performance and ensures high resistance to temperature and pressure changes.
- The upper cover is designed with a flat surface at the light beam exits to prevent the accumulation of water and ensure high luminous efficiency.
- Bulb fixing design based on suspension mounting to effectively extend bulb's lifetime
- Use of standard halogen reflector lamps.
- No adjustments required after lamp or another optical component replacement.
- High precision machining of parts and components to guarantee the quality and dimensions of each piece.
- Stainless steel hardware to grant the waterproof and corrosion resistance.
- Multi-slip waterproof gasket to ensure an appropriate seal with the base.
- Interchangeable components, usable in all lights of the range.

Specifications

- Power: 2.8A ~ 6.6 A.
- Lamp: 2x48W/6.6A or 2x105W/6.6A halogen lamp with reflector
- Lamp average life: More than 1.500h at maximum brightness and more than 3.000h in a normal operation conditions.
- Color: Green
- Index Protection: IP68.

THR-12 | In-pavement runway threshold light - Airsafe

Order Code

THR-12 - X - XXX - G

Type *THR-12 = 12" In-pavement runway threshold light*

Runway threshold

L = Left toe-in
R = Right toe-in
S = Straight

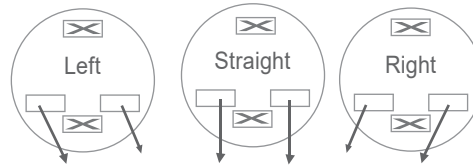

Beam direction

Power *096 = 2x48W*
210 = 2x105W

Beam color *G = Green*

Installation

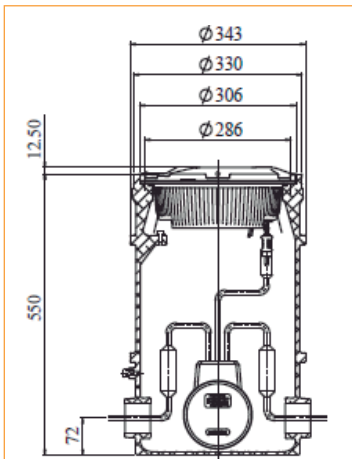

Figure 1
On 12" deep base

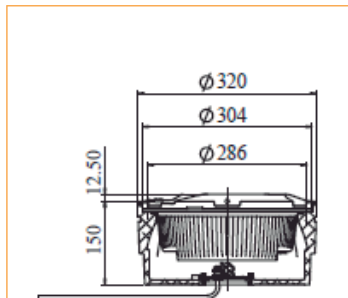
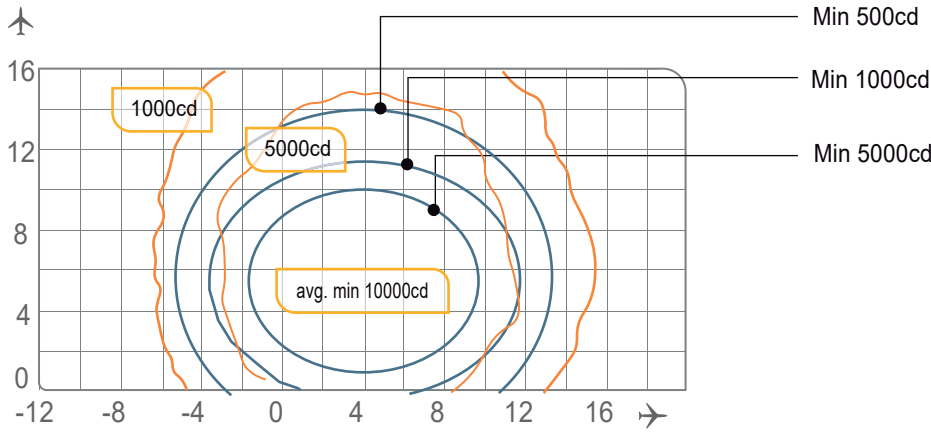

Figure 2
On 12" shallow base

THR-12 | In-pavement runway threshold light - Airsafe

Photometry



THR-12-X-210, ICAO Fig. A2-3, Green

Application		Main beam		Color	Required min. avg. cd.	Actual avg. cd.
		H	V			
THR-12-X-210	ICAO Fig A2-3	$\pm 5^\circ$ (Toe-in 4°)	2° a 9°	Green	10.000	12.750
	FAA L-850E	$\pm 6^\circ$	1° a 9°	Green	5.000	11.078
THR-12-X-096	FAA L-850D	$\pm 5,5^\circ$ (Toe-in $3,5^\circ$)	1° a 10°	Green	3.300	3.904



Structure

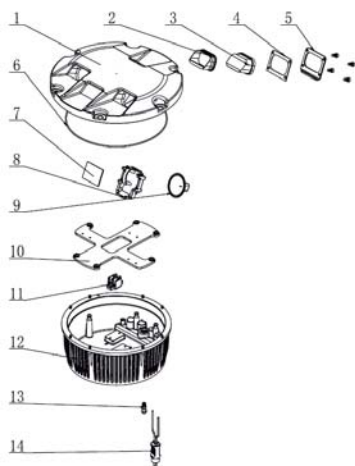

- 1 Upper cover
- 2 Prism gasket sleeve
- 3 Prism
- 4 Prism gasket
- 5 Prism pressing bracket
- 6 Light body gasket
- 7 Filter
- 8 Lamp holder
- 9 Lamp
- 10 Mounting plate
- 11 Terminal block
- 12 Inner cover
- 13 Valve
- 14 Plug

THR-12 | In-pavement runway threshold light - Airsafe

Spare Parts

N°	Order No.	Description
2	43107	Prism gasket sleeve
3	31141	Prism
4	43307	Prism gasket
5	43208	Prism pressing bracket
6	41135	Light body gasket
7	31316-G	Filter - Green
8	942133	Lamp holder
9	L64339	Halogen lamp 105W/6.6A
	L64337	Halogen lamp 48W/6.6A
11	941201	Terminal block
13	941801	Valve
14	HT70603	Secondary cable connector style 6

Accessories

N°	Order No.	Description
1	SB-12	12" shallow base
2	DB-12	12" deep base
3	41115	12" base O-ring gasket
4	51121	12" Lamp holder
5	ITF-200-066	200W isolation transformer
6	REC7	Secondary cable recetacle style 7

Weight and Dimensions

	Base	12" shallow base
Packaging size	330x330x150mm ³	340x340x190mm ³
Weight	7,3 kg	11,8 kg