

REL-12 | In-pavement runway edge light - Airsafe



COMPLIANCE:

- ICAO Annex.14 Vol.1
- FAA AC 150/5345-46
- IEC-TS 61827
- EASA: CS-ADR-DSN
- STANAG 3316
- AENA PPT-011-03-12

BOARDING PASS

NAME OF PASSANGER
FROM:
TO:
DATE
GATE 23 SEAT 21B
FLIGHT GAES2020

GATE CLOSES 30 MINUTES BEFORE DEPARTURE

GOMINTEC

BOARDING PASS

GOMINTEC

Uses

In-pavement runway edge light for airports CAT I, II & III, according to ICAO, Figure A2-9 & A2-10

Features

- 12" external diameter.
- Body casting manufactured on forged aluminum, with high strength and optimum mechanical performance.
- A patented prism design to guarantee an excellent optical performance and ensures high resistance to temperature and pressure changes.
- The upper cover is designed with a flat surface at the light beam exits to prevent the accumulation of water and ensure high luminous efficiency.
- Bulb fixing design based on suspension mounting to effectively extend bulb's lifetime
- Use of standard halogen reflector lamps.
- No adjustments required after lamp or another optical component replacement.
- High precision machining of parts and components to guarantee the quality and dimensions of each piece.
- Stainless steel hardware to grant the waterproof and corrosion resistance.
- Multi-slip waterproof gasket to ensure an appropriate seal with the base.
- Interchangeable components, usable in all lights of the range.

Specifications

- Power: 2.8A ~ 6.6 A.
- Lamp: 2x105W /6.6A. Halogen lamp with reflector
- Lamp average life: More than 1.500h at maximum brightness and more than 3.000h in a normal operation conditions.
- Colors: White, Yellow and Red
- Index Protection: IP68.

REL-12 | In-pavement runway edge light - Airsafe

Order Code

REL-12 - X - 210 - XX

Type *REL-12 = 12" in-pavement runway edge light*

L = Toe-in left
R = Toe-in right

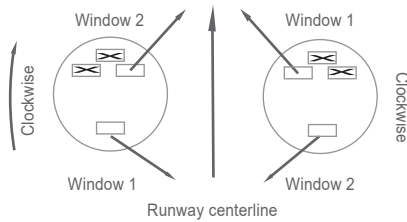

Beam Direction

Power *210 = 2x105W*

Beam color
YC = Window 1: yellow - Window 2: white
CY = Window 1: white - Window 2: yellow
CC = Window 1: white - Window 2: white
CR = Window 1: white - Window 2: red
RC = Window 1: red - Window 2: White



Installation

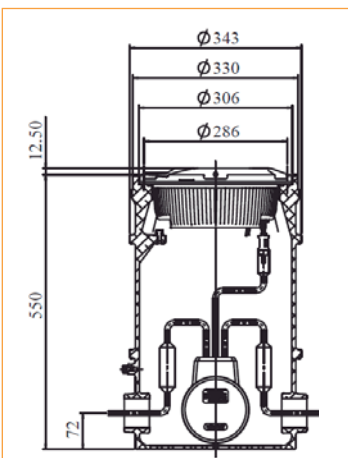

Figure 1
On 12" deep base

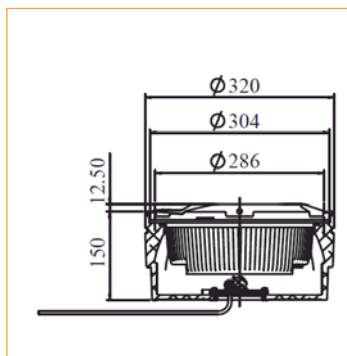
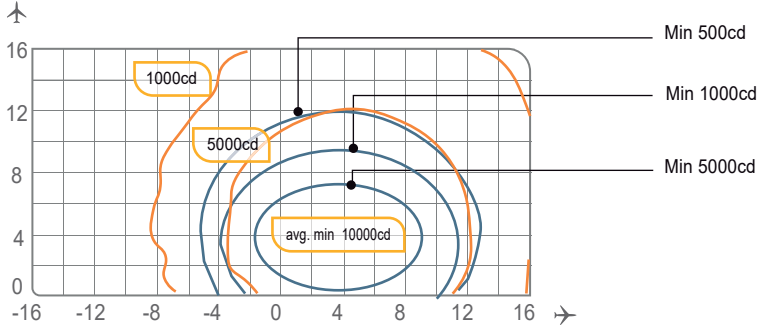

Figure 2
On 12" shallow base

REL-12 | In-pavement runway edge light - Airsafe

Photometry



REL-12, ICAO Fig. A2-9, White

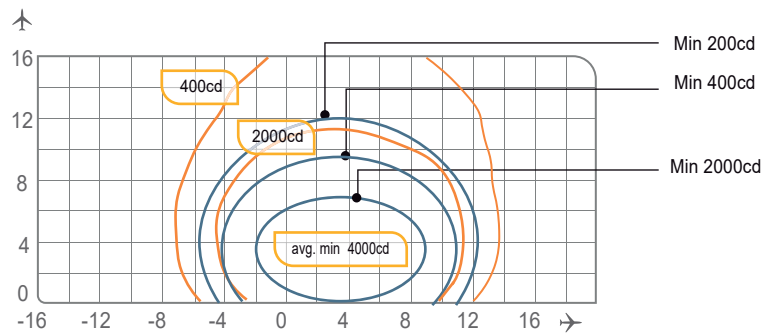

REL-12, ICAO Fig. A2-9, Yellow

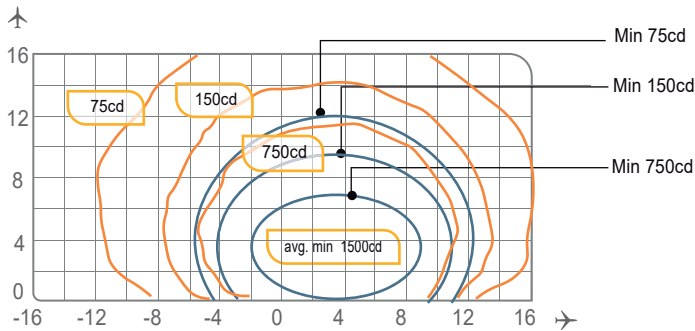

REL-12, ICAO Fig. A2-9, Red

Application		Main beam		Color	Required min. avg. cd.	Actual avg. cd.
		H	V			
REL-12	ICAO Fig A2-9	$\pm 5,5^\circ$ (Toe-in $3,5^\circ$)	0° a 7°	White	10.000	11.152
				Yellow	4.000 (5.000)	4.869
				Red	1.500 (2.000)	2.354
	ICAO Fig A2-10	$\pm 6,5^\circ$ (Toe-in $4,5^\circ$)	0° a 7°	White	1.000	10.500
				Yellow	4.000 (5.000)	4.602
				Red	1.500 (2.000)	2.214

REL-12 | In-pavement runway edge light - Airsafe



Structure

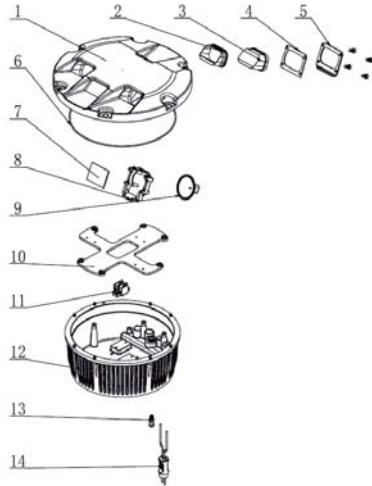

- 1 Upper cover
- 2 Prism gasket sleeve
- 3 Prism
- 4 Prism gasket
- 5 Prism pressing bracket
- 6 Light body gasket
- 7 Filter
- 8 Lamp holder
- 9 Lamp
- 10 Mounting plate
- 11 Terminal block
- 12 Inner cover
- 13 Valve
- 14 Plug

Spare Parts

N°	Order No.	Description
2	43107	Prism gasket sleeve
3	31141	Prism
4	43307	Prism gasket
5	43208	Prism pressing bracket
6	41135	Light body gasket
7	31316-Y	Filter yellow
7	31316-R	Filter red
8	942133	Lamp holder
9	L64339	Lamp
11	941201	Terminal block
13	941801	Valve
14	HT70603	Plug

REL-12 | In-pavement runway edge light - Airsafe

Accessories

N°	Order No.	Description
1	SB-12	12" shallow base
2	DB-12	12" deep base
3	41115	12" base O-ring gasket
4	51121	12" lamp holder
5	ITF-300-066	300W isolation transformer
6	REC7	Secondary cable receptacle style 7



Weight and Dimensions

	Base	8" shallow base
Packaging size	330x330x150mm ³	340x340x190mm ³
Weight	7,3 kg	11,8 kg