

TAE-12 | In-pavement runway threshold/End light - Airsafe



COMPLIANCE:

- ICAO Annex.14 Vol.1
- FAA AC 150/5345-46
- IEC-TS 61827
- EASA: CS-ADR-DSN
- STANAG 3316
- AENA PPT-010_03-12



BOARDING TIME



BOARDING PASS

NAME OF PASSANGER

FROM:

TO:

DATE

FLIGHT
GAES2020

GATE 23 SEAT 21B

GATE CLOSES 30 MINUTES BEFORE DEPARTURE

GOMINTEC BOARDING PASS GOMINTEC

Uses

In-pavement runway threshold/end light for airports CAT I, II & III, according to ICAO, Figure 2-3 & A2-8.

Features

- 12" external diameter.
- Body casting manufactured on forged aluminum, with high strength and optimum mechanical performance.
- A patented prism design to guarantee an excellent optical performance and ensures high resistance to temperature and pressure changes.
- The upper cover is designed with a flat surface at the light beam exits to prevent the accumulation of water and ensure high luminous efficiency.
- Bulb fixing design based on suspension mounting to effectively extend bulb's lifetime
- Use of standard halogen reflector lamps.
- No adjustments required after lamp or another optical component replacement.
- High precision machining of parts and components to guarantee the quality and dimensions of each piece.
- Stainless steel hardware to grant the waterproof and corrosion resistance.
- Multi-slip waterproof gasket to ensure an appropriate seal with the base.
- Interchangeable components, usable in all lights of the range.

Specifications

- Power: 2.8A ~ 6.6 A.
- Lamp: 2x105W/6.6A or 3x105W/6.6A halogen lamp with reflector
- Lamp average life: More than 1.500h at maximum brightness and more than 3.000h in a normal operation conditions.
- Colors: Green and red
- Index Protection: IP68.

TAE-12 | In-pavement runway threshold/End light - Airsafe

Order Code

TAE-12 - X - 315 - GR - XX

Type *TAE-12 = 12" in-pavement runway threshold/end light*

L = Left toe-in
R = Right toe-in
S = Straight

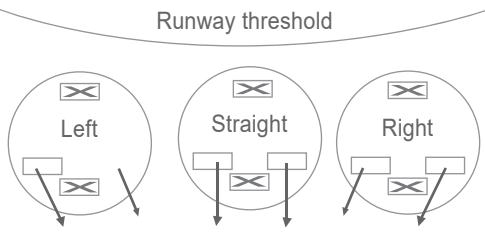

Beam direction

Power *210 = 2x105W*
315 = 3x105W

Beam color *GR = one side is green, another side is red*

Plug *1P = 1 plug*
2P = 2 plugs

Installation

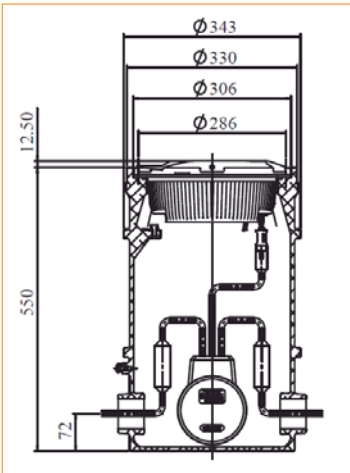

Figure 1
On 12" deep base

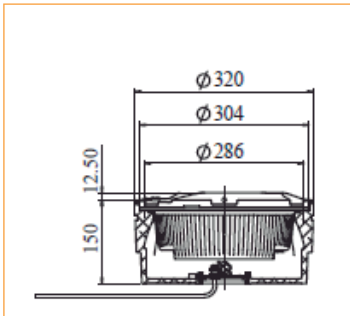
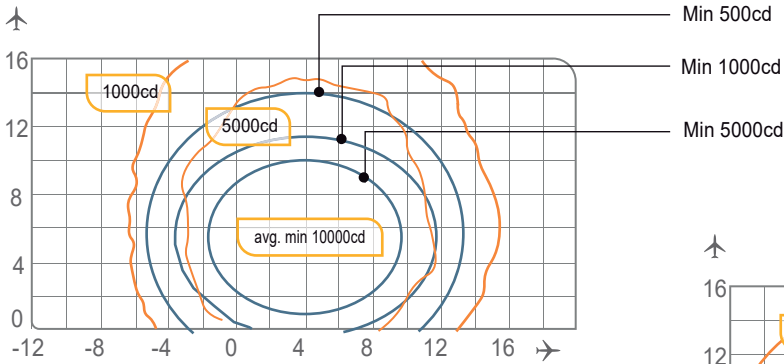

Figure 2
On 12" shallow base

TAE-12 | In-pavement runway threshold/End light - Airsafe

Photometry



TAE-12-X-315, ICAO Fig. A2-3, Green

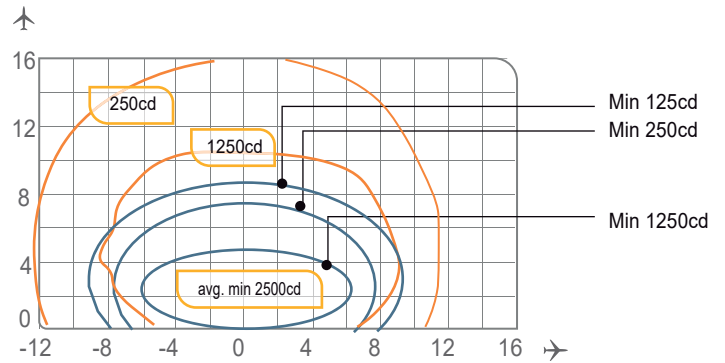

TAE-12-X-315, ICAO Fig. A2-8, Red

Application		Main beam		Color	Required min. avg. cd.	Actual avg. cd.
		H	V			
TAE-12-X-315	ICAO Fig A2-3	$\pm 5,5^\circ$ (Toe-in $3,5^\circ$)	1° a 10°	Green	10.000	11.096
	ICAO Fig A2-8	$\pm 6^\circ$	$0,25^\circ$ a $4,75^\circ$	Red	2.500	2.727
TAE-12-X-210	FAA L-850D	$\pm 5,5^\circ$ (Toe-in $3,5^\circ$)	1° a 10°	Green	3.300	3.904
		$\pm 6^\circ$	$0,2^\circ$ a $4,7^\circ$	Red	2.500	2.603



Structure

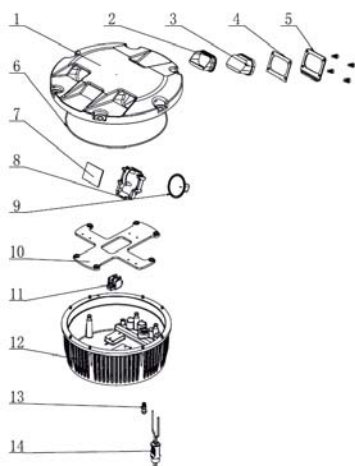

- 1 Upper cover
- 2 Prism gasket sleeve
- 3 Prism
- 4 Prism gasket
- 5 Prism pressing bracket
- 6 Light body gasket
- 7 Filter
- 8 Lamp holder
- 9 Lamp
- 10 Mounting plate
- 11 Terminal block
- 12 Inner cover
- 13 Valve
- 14 Plug

TAE-12 | In-pavement runway threshold/End light - Airsafe

Spare Parts

N°	Order No.	Description
2	43107	Prism gasket sleeve
3	31141	Prism
4	43307	Prism gasket
5	43208	Prism pressing bracket
6	41135	Light body bracket
7	31316-G	Filter-green
7	31316-R	Filter-red
8	942133	Lamp holder
9	L64339	Halogen lamp 105W/6.6A
11	941201	Terminal block
13	941801	Valve
14	HT70603	Secondary cable connector style 6

Accessories

N°	Order No.	Description
1	SB-12	12" shallow base
2	DB-12	12" deep base
3	41115	12" base O-ring gasket
4	51121	12" lamp holder
5	ITF-300-066	300W isolation transformer
6	REC7	Secondary cable receptacle style 7

Weight and Dimensions

	Base	12" shallow base
Packaging size	330x330x150mm ³	340x340x190mm ³
Weight	7,3 kg	11,8 kg