

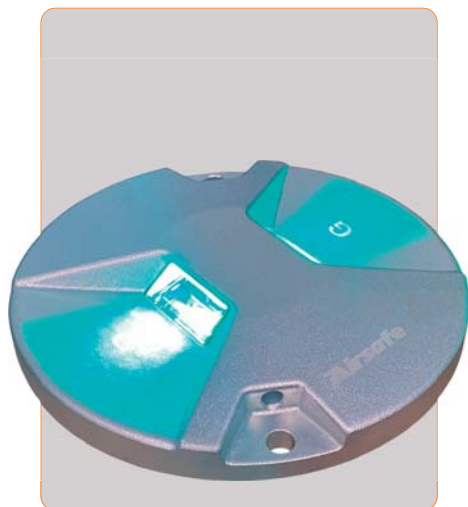

TCLM-08 | In-pavement taxiway centerline light - Airsafe



COMPLIANCE:

- ICAO Annex.14 Vol.1
- FAA AC 150/5345-46
- IEC-TS 61827
- EASA: CS-ADR-DSN
- STANAG 3316
- AENA PPT-013_03-12



BOARDING TIME

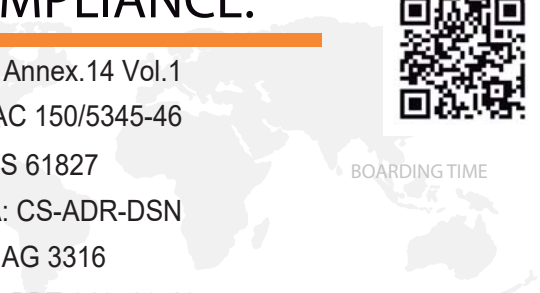

BOARDING PASS

NAME OF PASSANGER

FROM:

TO:

DATE FLIGHT
 GAES2020

GATE SEAT
23 21B

GATE CLOSSES 30 MINUTES BEFORE DEPARTURE

GOMINTEC BOARDING PASS GOMINTEC

Uses

In-pavement taxiway centerline light for airports CAT I, II & III, according to ICAO, Figures A2-12, A2-13 & A2-14.

Features

- 8" external diameter.
- Body casting manufactured on forged aluminum, with high strength and optimum mechanical performance.
- A patented prism design to guarantee an excellent optical performance and ensures high resistance to temperature and pressure changes.
- The upper cover is designed with a flat surface at the light beam exits to prevent the accumulation of water and ensure high luminous efficiency.
- Bulb fixing design based on suspension mounting to effectively extend bulb's lifetime
- Use of standard halogen reflector lamps.
- No adjustments required after lamp or another optical component replacement.
- High precision machining of parts and components to guarantee the quality and dimensions of each piece.
- Stainless steel hardware to grant the waterproof and corrosion resistance.
- Multi-slip waterproof gasket to ensure an appropriate seal with the base.
- Interchangeable components, usable in all lights of the range.

Specifications

- Power: 2.8A ~ 6.6 A.
- Lamp: 1x48W /6.6A halogen lamp with reflector.
- Lamp average life: More than 1.500h at maximum brightness and more than 3.000h in a normal operation conditions.
- Colors: Yellow and Green
- Index Protection IP68.

TCLM-08 | In-pavement taxiway centerline light - Airsafe

Order Code

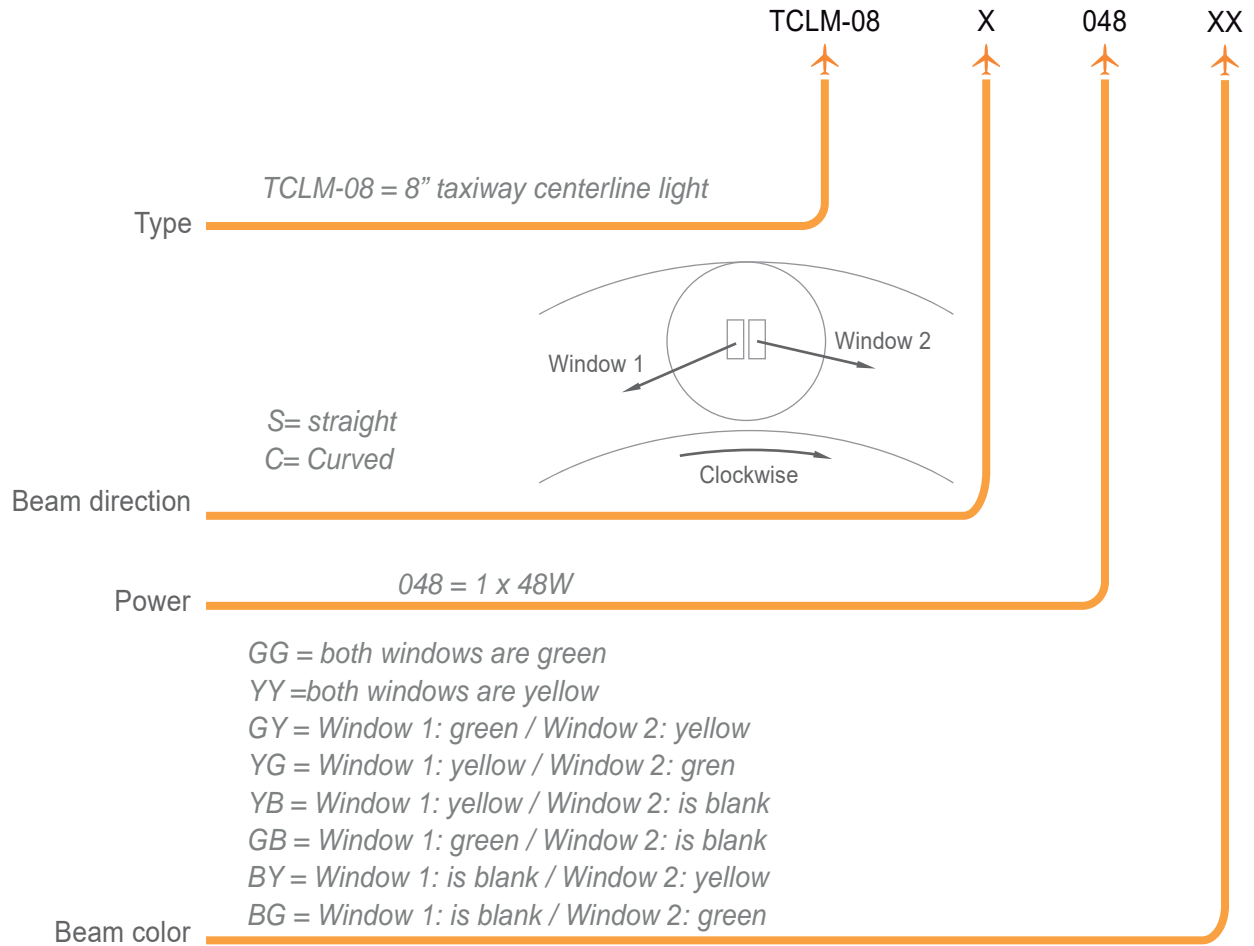

Installation

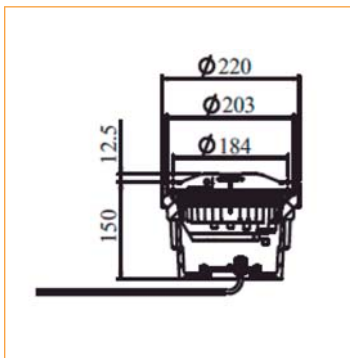

Figure 1
On 8" shallow base

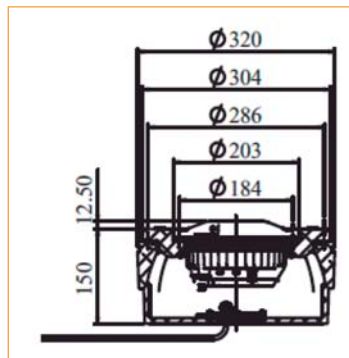

Figure 2
*On 12" shallow base with
12 7/8" adapter ring*

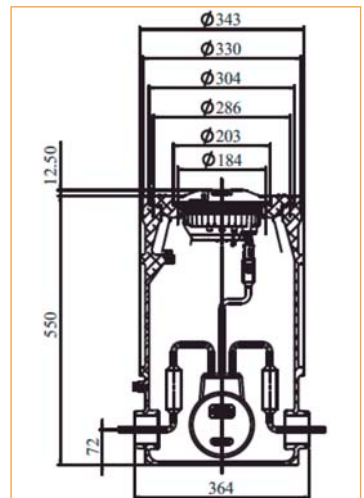
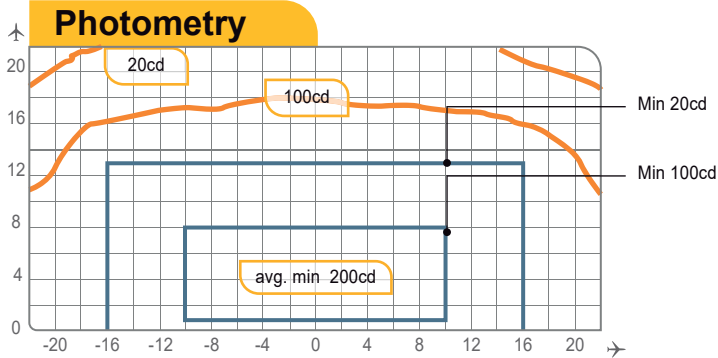
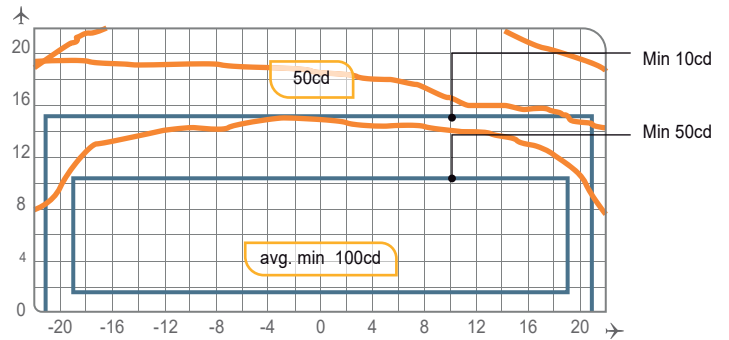

Figure 3
*On 12" deep base with
12 7/8" adapter ring*

TCLM-08 | In-pavement taxiway centerline light - Airsafe



TCLM-08, ICAO Fig. A2-12, green



TCLM-08, ICAO Fig. A2-14, green

Application		Main beam		Color	Required min. avg. cd.	Actual avg. cd.
		H	V			
TCLM-08-S	FAA L-852C ICAO Fig A2-13	$\pm 3.5^\circ$	1 a 8°	Green	200	440
				Yellow	200	526
	FAA L-852C ICAO Fig A2-12	$\pm 10^\circ$	1 a 8°	Green	200	365
				Yellow	200	458
TCLM-08-C	FAA L-852K ICAO Fig A2-14	$\pm 19,25^\circ$ (toe-in $15,75^\circ$)	1 a 10°	Green	100	238
				Yellow	100	246



Structure

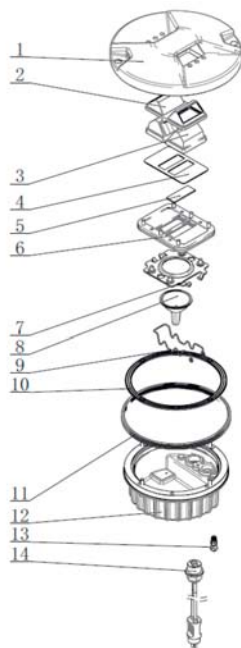

- 1 Upper cover
- 2 Prism gasket sleeve
- 3 Prism
- 4 Prism gasket
- 5 Filter
- 6 Prism pressing gasket
- 7 Lamp holder
- 8 Lamp
- 9 Pressure spring for lamp
- 10 Light body gasket
- 11 Lighting fixture gasket
- 12 Inner cover
- 13 Valve
- 14 Plug

Spare Parts

N°	Order No.	Description
2	43109	Prism gasket sleeve (unidirectional)
	43106	Prism gasket sleeve (bidirectional)
3	31136	Prism H29 – left toe-in
	31137	Prism H29 – Right toe-in
	31135	Prism H29 – Straight
4	43312	Prism gasket
5	31324-G	Filter - Green
	31324-Y	Filter - Yellow
6	43221	Prism pressing bracket
8	L64337	Lamp
9	44209	Lamp pressure spring
10	41141	Light body gasket
11	41107	Light fixture gasket
13	941801	Valve
14	HT 70603	Plug

Accessories

N°	Order No.	Description
1	SB-08	8" shallow base
2	SB-12	12" shallow base
3	DB-12	12" deep base
4	AR 12/08	12" - 8" adapter ring assy
5	951101	8" lamp holder
6	ITF-065-066	65W isolation transformer
7	REC7	Secondary cable connector Style 7



Weight and Dimensions

	Base	8" shallow base
Packaging size	210x210x130mm ³	240x240x180mm ³
Weight	3,1 kg	6,0 kg