

## SBLM-08 | In-pavement stop-bar light - Airsafe



### COMPLIANCE:

- ICAO Annex.14 Vol.1
- FAA AC 150/5345-46
- IEC-TS 61827
- EASA: CS-ADR-DSN
- STANAG 3316
- AENA PPT\_018-03\_12



BOARDING TIME

### BOARDING PASS

NAME OF PASSANGER

FROM:

TO:

DATE

FLIGHT  
GAES2020

GATE

23

SEAT

21B

GATE CLOSES 30 MINUTES BEFORE DEPARTURE

GOMINTEC

BOARDING PASS

GOMINTEC

### Uses

In-pavement stop-bar light for airports CAT I, II & III, according to ICAO, Figure A2-12.

### Features

- 8" external diameter.
- Body casting manufactured on forged aluminum, with high strength and optimum mechanical performance.
- A patented prism design to guarantee an excellent optical performance and ensures high resistance to temperature and pressure changes.
- The upper cover is designed with a flat surface at the light beam exits to prevent the accumulation of water and ensure high luminous efficiency.
- Bulb fixing design based on suspension mounting to effectively extend bulb's lifetime
- Use of standard halogen reflector lamps.
- No adjustments required after lamp or another optical component replacement.
- High precision machining of parts and components to guarantee the quality and dimensions of each piece.
- Stainless steel hardware to grant the waterproof and corrosion resistance.
- Multi-slip waterproof gasket to ensure an appropriate seal with the base.
- Interchangeable components, usable in all lights of the range.

### Specifications

- Power: 2.8A ~ 6.6 A.
- Lamp: 1x48W/6.6A halogen lamp with reflector.
- Lamp average life: More than 1.500h at maximum brightness and more than 3.000h in a normal operation conditions.
- Colors: Red and blank
- Index Protection: IP68.

**SBLM-08 | In-pavement stop-bar light - Airsafe**

**Order Code**

SBLM-08 - X - 048 - RB

SBLM-08 = 8" in-pavement stop-bar light

Type

Beam direction

Lamp power

Beam color

S = Straight

048 = 1x48W

RB = Red and blank

**Installation**

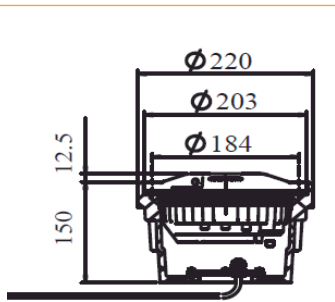

**Figure 1**  
On 8" shallow base

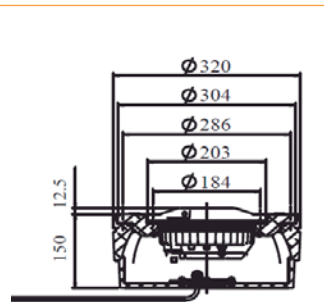

**Figure 2**  
On 12" shallow base with  
12"x8" adapter ring

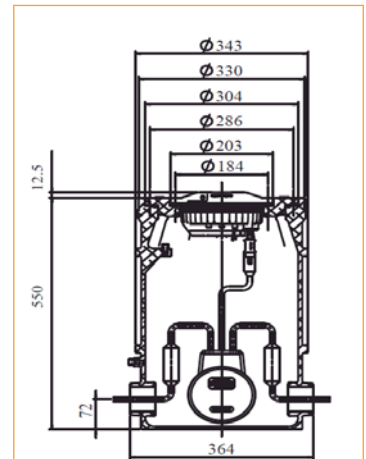

**Figure 3**  
On 12" deep base with  
12"x8" adapter ring

## SBLM-08 | In-pavement stop-bar light - Airsafe

### Photometry

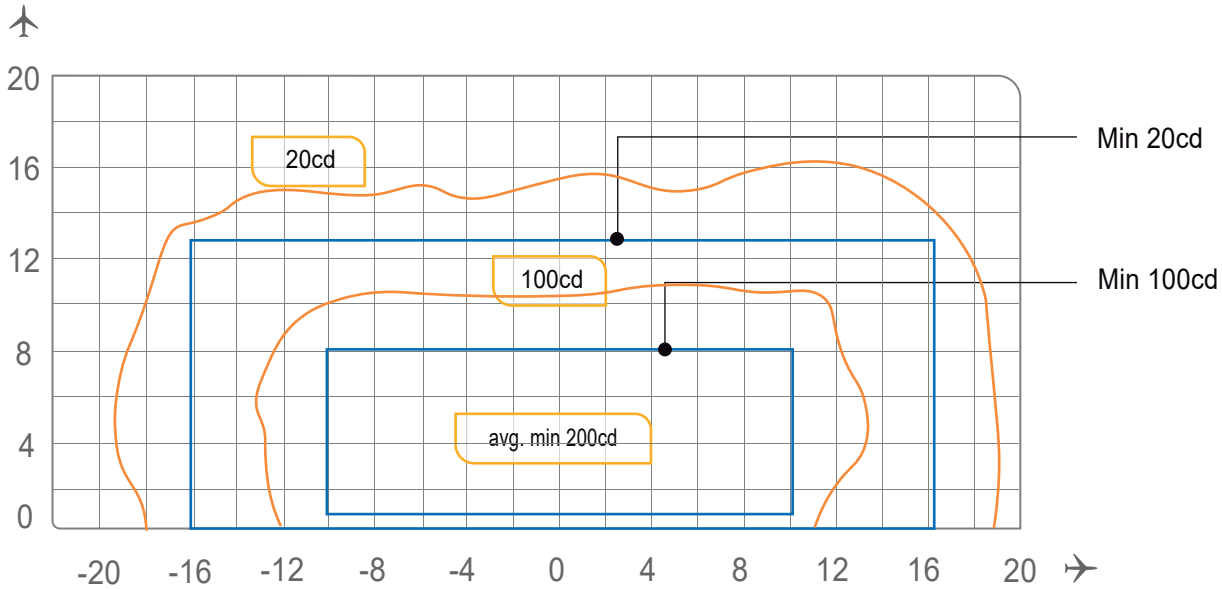

SBLM-08, ICAO Fig. A2-12, Red

Application		Main beam		Color	Required min. avg. cd.	Actual avg. cd.
		H	V			
SBLM-08	ICAO Fig A2-12	$\pm 10^\circ$	$1^\circ$ a $8^\circ$	Red	200	283



### Structure

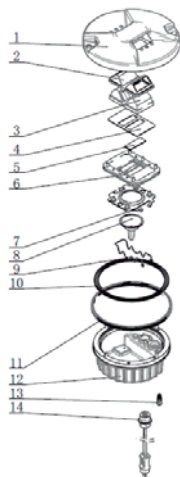

- 1 Upper cover
- 2 Prism gasket sleeve
- 3 Prism
- 4 Prism gasket
- 5 Filter
- 6 Prism pressing bracket
- 7 Lamp holder
- 8 Lamp
- 9 Pressure spring for lamp
- 10 Light body gasket
- 11 Lighting fixture gasket
- 12 Inner cover
- 13 Valve
- 14 Plug

## SBLM-08 | In-pavement stop-bar light - Airsafe

### Spare Parts

N°	Order No.	Description
2	43109	Prism gasket sleeve
3	31135	Prism
4	43312	Prism gasket
5	31324-R	Filter - red
6	43221	Prism pressing bracket
8	L64337	Halogen lamp 48W/6.6A
9	44209	Lamp pressure spring
10	41141	Light body gasket
11	41107	Light fixture gasket
13	941801	Valve
14	HT70603	Plug

### Accessories

N°	Order No.	Description
1	SB-08	8" shallow base
2	SB-12	12" shallow base
3	DB-12	12" deep base
4	AR-12/08	12"-8" adapter ring assy
5	951101	8" lamp holder
6	ITF-065-066	65W isolation transformer
7	REC7	Secondary cable receptacle style 7



### Weight and Dimensions

	Base	8" shallow base
<b>Packaging size</b>	210x210x130mm <sup>3</sup>	240x240x180mm <sup>3</sup>
<b>Weight</b>	3,1 kg	6,0 kg