

EOL-OB-LED | LED elevated obstacle light (low intensity) - Airsafe



COMPLIANCE:

- ICAO Annex.14, Vol I.
- FAA AC 150/5345-46
- IEC-TS 61827
- EASA CS-ADR-DSN.
- STANAG 3316

BOARDING TIME

BOARDING PASS

NAME OF PASSANGER

FROM:

TO:

DATE

GATE 23 SEAT 21B

FLIGHT GAES2020

GATE CLOSSES 30 MINUTES BEFORE DEPARTURE

GAES 454843121451100

GOMINTEC BOARDING PASS GOMINTEC

Uses

LED elevated low-intensity obstacle light for airports CAT I, II & III, according to ICAO Art.5.3.18.8

Features

- Robust body built on high strength aluminum alloy, anti-corrosion treatment and excellent thermal dissipation.
- Reduced height to minimize the jet blast impact.
- Stainless steel hardware to grant the waterproof and corrosion resistance.
- Glass diffuser with high resistance to the temperature and abrasion.
- Long-life and robust design to guarantee the waterproof of the equipment over the years.
- Integrated electronic encapsulated in epoxy resin.
- Compatible with existing serial circuits without need of changing the isolation transformers.
- Regulated light output.
- Optional "Fail Open" monitoring device.
- Integrated surge protection.
- Efficient control of LEDs operating temperature, increasing the light life and avoiding color change.
- Saturated LED colors ensuring clear identification of the lights at all brightness levels and any viewing angle.
- The long-life of the equipments, with low maintenance and consumption, involve directly a reduction of operational costs.
- Optional anti-birds device available.

Specifications

- Power: 2.8A ~ 6.6A, according to FAA EB67.
- Average life: minimum 60.000h at maximum brightness and 100.000h in a normal operating conditions.
- Color: Red
- Consumption: ≤ 5VA, FP ≥ 0.95
- Index Protection: IP66
- Installation with 15W isolation transformer

EOL-OB-LED | LED elevated obstacle light (low intensity) - Airsafe

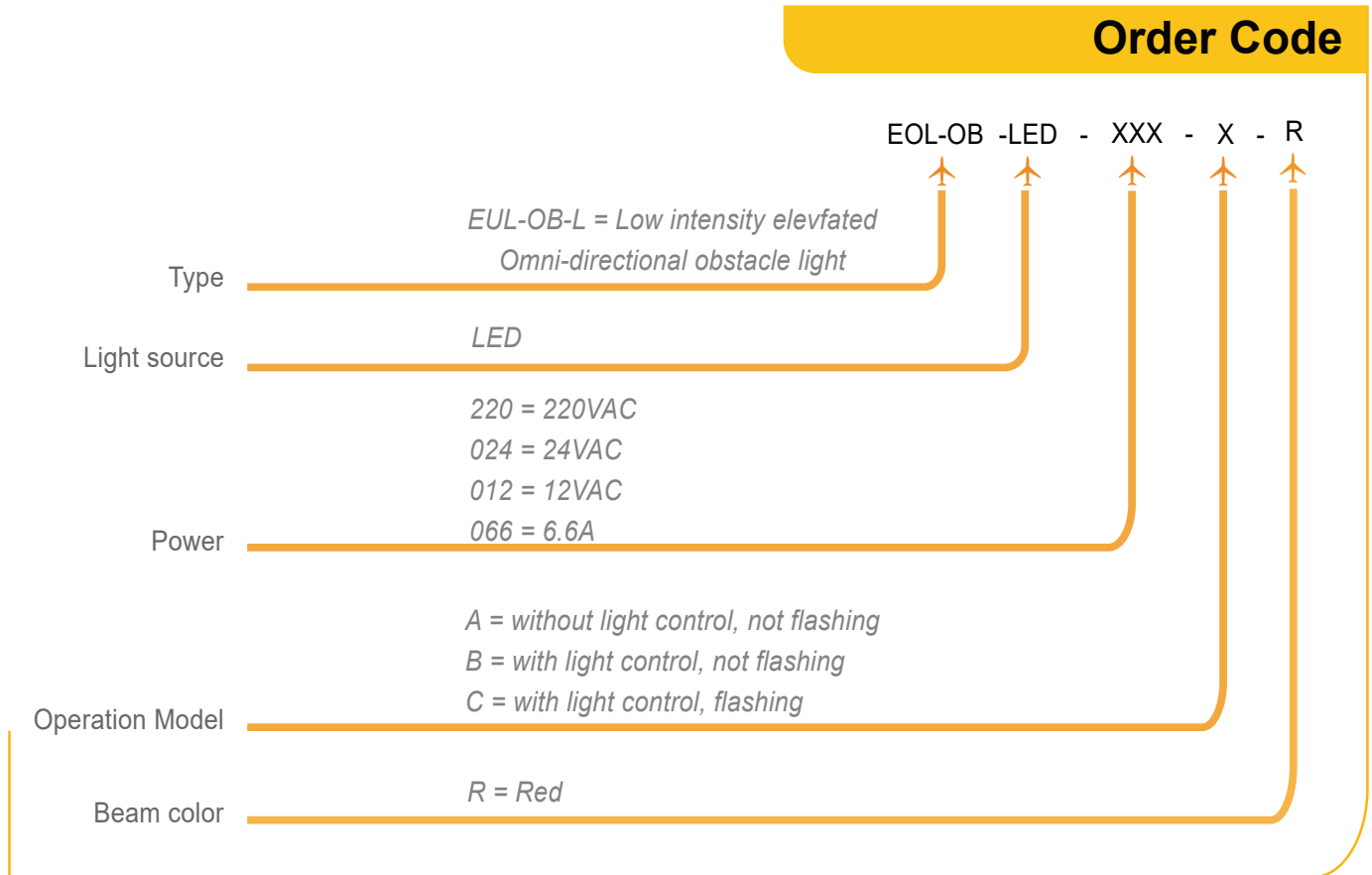

Installation

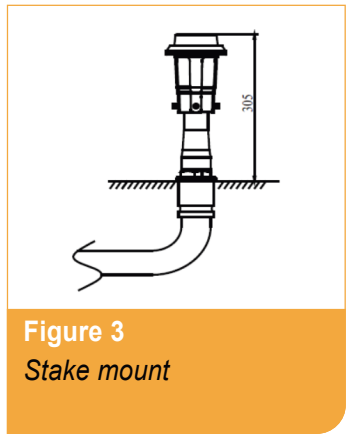
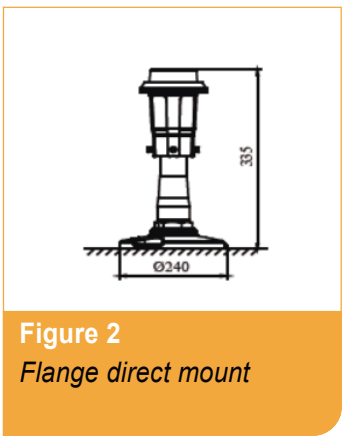
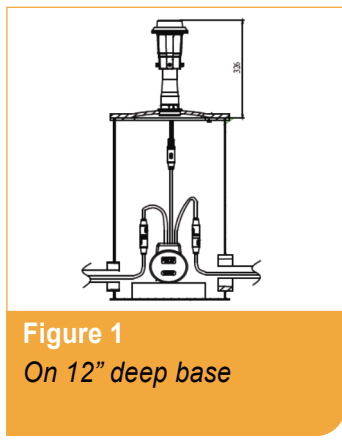

EOL-OB-LED | LED elevated obstacle light (low intensity) - Airsafe

Photometry

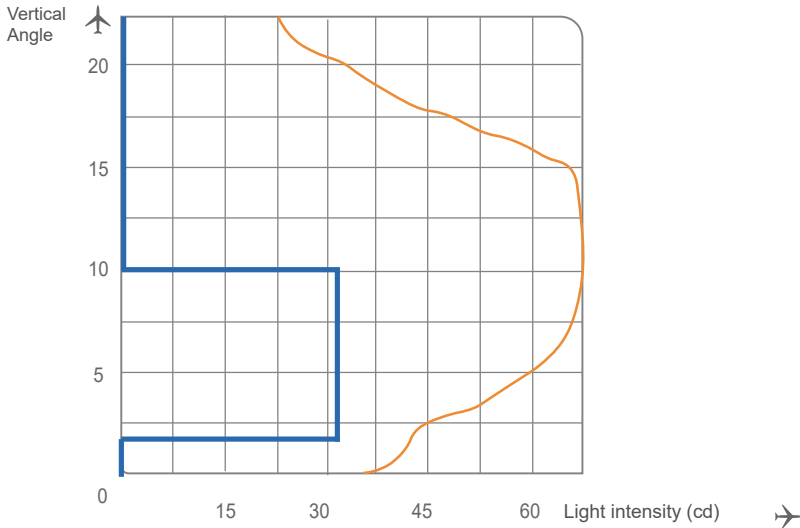

EUL - OB - LED, ICAO Art. 5.3.18.8, Red

Application	Main beam		Color	Required min. avg. cd.	Actual avg. cd.	
	H	V				
EOL-OB-LED	ICAO Art. 5.3.18.8 FAA L810	360°	0 a 10°	Red	32 / 32,5	35



Structure

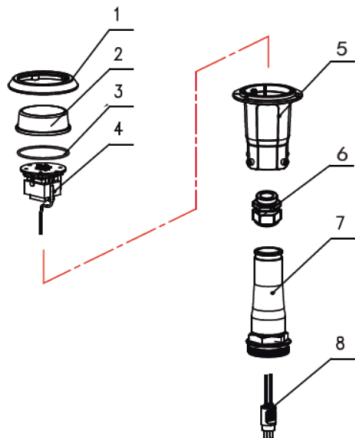

- 1 Upper cover
- 2 Prism
- 3 Light body gasket
- 4 Photoelectric assy
- 5 Light body
- 6 Waterproof gland
- 7 Frangible pole
- 8 Plug

Spare Parts

N°	Order No.	Description
2	931116	Prism
3	41114	Body seal gasket
7	24211	Frangible pole
8	HT70603	Secondary cable connector type A6

Accessories

N°	Order No.	Description
1	FL-10	Flange 10"
2	FL-12-X-G2	Flange 12"
3	54101	Six angle wrench
4	ITF-015-066	15W isolation transformer
5	REC 7	Secondary cable connector style 7
6	954211	Corrector
7	TJB-12	Isolation transformer box



Weight and Dimensions

- | | |
|-------------------------|--------------------------------|
| • Packaging size | 300 × 255 × 380mm ³ |
| • Weight | 5,50 kg |