

RCLS-12-LED

In-pavement LED runway centerline light - Airsafe



COMPLIANCE:

- ICAO Annex.14 Vol.1
- FAA AC 150/5345-46
- IEC-TS 61827
- EASA: CS-ADR-DSN
- STANAG 3316
- AENA PPT-013_03-12



BOARDING TIME



BOARDING PASS

NAME OF PASSANGER

FROM:

TO:

DATE

GATE 23

FLIGHT GAES2020

SEAT 21B

GATE CLOSSES 30 MINUTES BEFORE DEPARTURE

BOARDING PASS

Uses

In-pavement LED runway centerline lights for airports CAT II y III, according to ICAO, Figures A2-6 & A2-7.

Features

- 12" external diameter, with upper cover manufactured on high strength forged aluminum, and only 6mm of profile over pavement.
- Stainless steel hardware. Same pieces in 8" and 12" high intensity lights for easy maintenance and reduce spare parts requirements and stock.
- Uni-directional and bi-directional configuration.
- Surface treatment to prevent the wear and increase the corrosion resistance, which makes it especially resistant to dust and water.
- Smooth surface without sharpened edges to avoid damages at the aircraft tyres.
- Electronic converter with monitoring system "Fail Open" in the 5 brightness levels.
- Regulation according to FAA EB67E equivalent to a halogen lamp.
- Integrated surge protection.
- Efficient control of LEDs operating temperature, increasing the light life and avoid color change.
- High features optical design.
- Compatible with existing circuits of visual aids.
- Leak and Photometry test in factory.

Specifications

- Power: 2.8A ~ 6.6A/50Hz, according to FAA EB67D.
- Average life: minimum 60.000h at maximum brightness and 100.000h in a normal operating conditions.
- Colors: Red and White
- Consumption: 24VA (bi-direccional) - 18VA (uni-direccional) ; FP >0,95
- Index Protection: IP68.

Order Code

RCLS-12 - LED - XX - XP - M

Type *RCLS-12 = 12" runway centerline light*

Light source *LED*

Beam color
CC = Both windows: white
CR = Window 1: white / Window 2: red
CB = Window 1: white / Window 2: in blank
RB = Window 1: red / Window 2: in blank

Plug
1P = 1 plug
2P = 2 plugs

Optional functions
M = Single lamp fault detection function

Installation

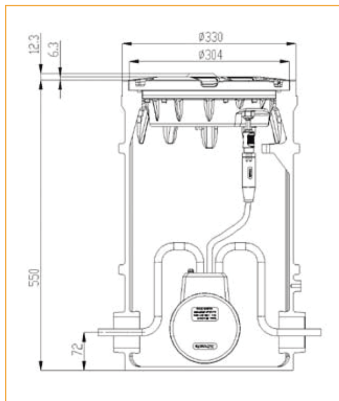

Figure 1
On 12" deep base

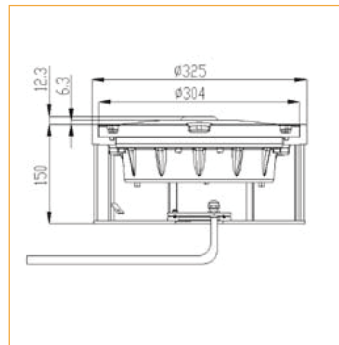
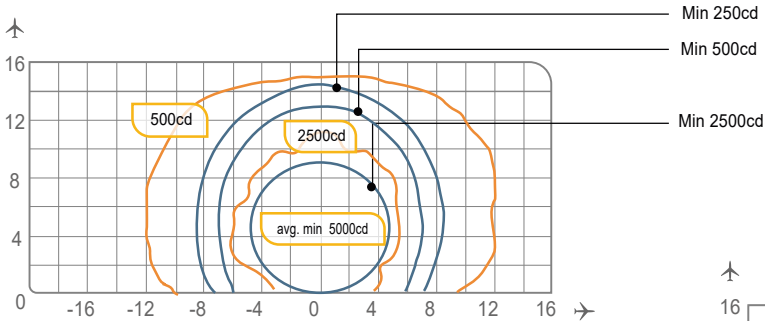

Figure 2
On 12" shallow base

RCLS-12-LED | In-pavement LED runway centerline light - Airsafe

Photometry



RCLS-12-LED, ICAO Fig. A2-7, White

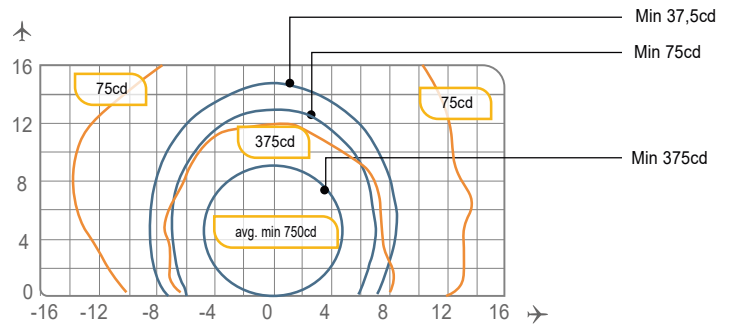

RCLS-12-LED, ICAO Fig. A2-7, Red

Application		Main beam		Color	Required min. avg. cd.	Actual avg. cd.
		H	V			
RCLS-12-LED	ICAO Fig A2-7	±5°	0° a 9° / 0,2° a 9°	White	5.000	7.184
				Red	750	1.598
	ICAO Fig A2-6	±5°	0° a 7°	White	5.000	7.381
				Red	750	1.567



Structure

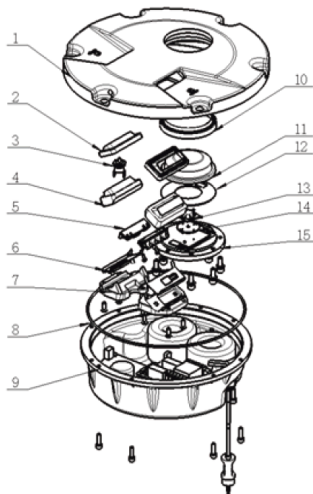

- 1 Upper cover
- 2 Prism gasket sleeve
- 3 Thermal switch
- 4 Prism
- 5 LED lamp assy
- 6 Prism gasket
- 7 Prism pressing bracket
- 8 Light body gasket
- 9 Inner cover assy
- 10 O-prism gasket sleeve
- 11 O-Prism
- 12 O-Prism gasket
- 13 O-LED lens
- 14 O-LED lamp assy
- 15 O-Prism pressing bracket

RCLS-12-LED | In-pavement LED runway centerline light - Airsafe

Spare Parts

N°	Order No.	Description
2	43117	Prism gasket sleeve
4	31158	Prism
5	932053-RELS-R	LED lamp assy - RUNWAY-R-RELS
5	932053-RELS-C	LED lamp assy - RUNWAY-C-RELS
6	43316	Prism gasket
7	43241	Prism pressing bracket
8	41135	Light body gasket
10	43115	O-prism gasket sleeve
11	31113	O-prism
13	43322	O-prism gasket
14	979271-C	O-LED lamp assy
15	43217	O-prism pressing bracket

Accessories

N°	Order No.	Description
1	SB-12	12" deep base
2	DB-12	12" shallow base
3	41115	12" base O-ring
4	51121	12" lamp handle
5	ITF-065-066	65W isolation transformer
6	REC7	Moulded type decondary cable receptacle style 7



Weight and Dimensions

	Base	12" shallow base
Packaging size	330x330x150mm ³	350x350x185mm ³
Weight	9,7 kg	14,3 kg