

## COMPLIANCE:

- ICAO Annex. 14 Vol.I
- FAA AC 150/5345-46
- IEC-TS 61827
- EASA: CS-ADR-DSN
- STANAG 3316
- AENA PPT-013\_03-12



## BOARDING PASS

NAME OF PASSANGER

FROM:

TO:

DATE

GATE  
23

BOARDING TIME

FLIGHT  
GAES2020

SEAT  
21B

GATE CLOSSES 30 MINUTES BEFORE DEPARTURE

GOMINTEC

BOARDING PASS

GOMINTEC

## Uses

LED in-pavement rapid exit taxiway centerline light for airports CAT I, II & III, according to ICAO Figure A2-12.

## Features

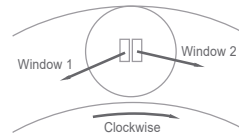
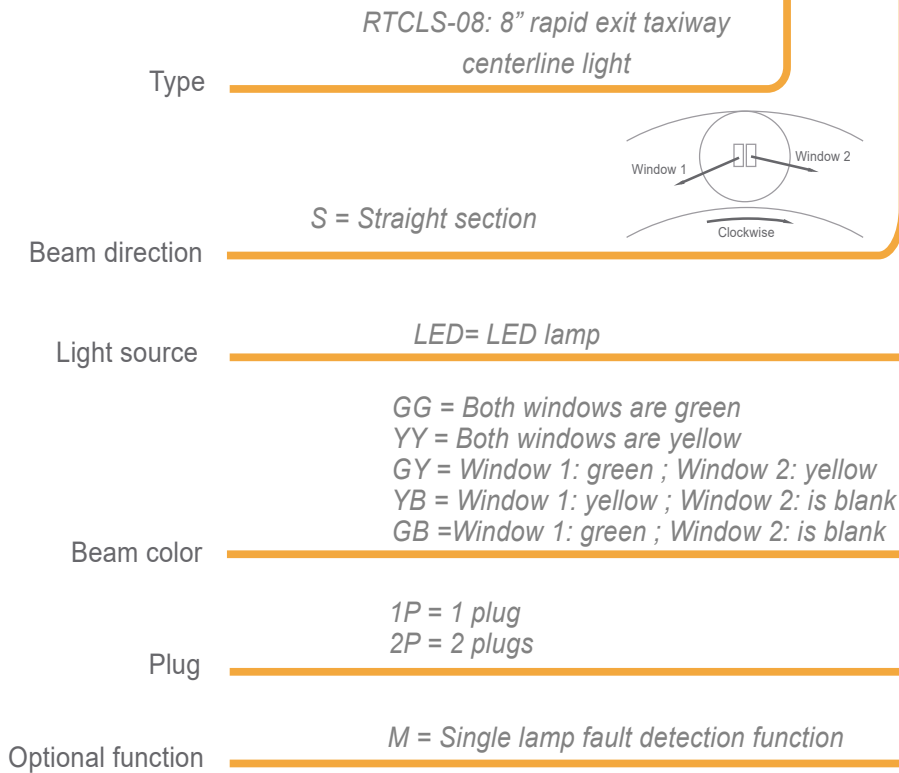
- 8" external diameter, with upper and lower cover manufactured on high strength forged aluminum, and only 6mm of profile over pavement.
- Stainless steel hardware.
- Uni-directional and bi-directional configuration.
- Surface treatment to prevent the wear and increase the corrosion resistance, which makes it especially resistant to dust and water.
- Smooth surface without sharpened edges to avoid damages at the aircraft tyres.
- Regulation according to FAA EB67E equivalent to a halogen lamp.
- Integrated surge protection.
- Efficient control of LEDs operating temperature, increasing the light life and avoid color change.
- High features optical design.
- Compatible with existing circuits of visual aids.

## Specifications

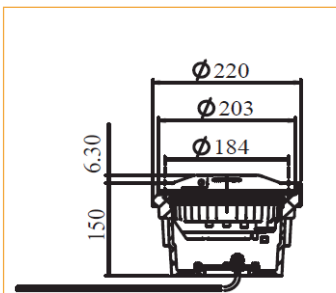
- Power: 2.8A ~ 6.6A, according to FAA EB67D.
- Average life: minimum 60.000h at maximum brightness and 100.000h in a normal operating conditions.
- Colors: Green and Yellow
- Consumption: 28VA (XX-2P), 14VA (XX-1P), 7VA (XB-1P); FP >0,95
- Index Protection: IP68.
- Installation with 25W isolation transformer

### Order Code

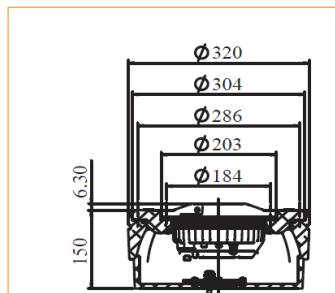
RTCLS-08 - X - LED - XX - XX - X



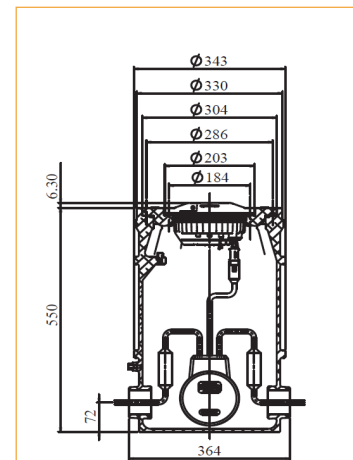
### Installation



**Figure 1**  
On 8" shallow base

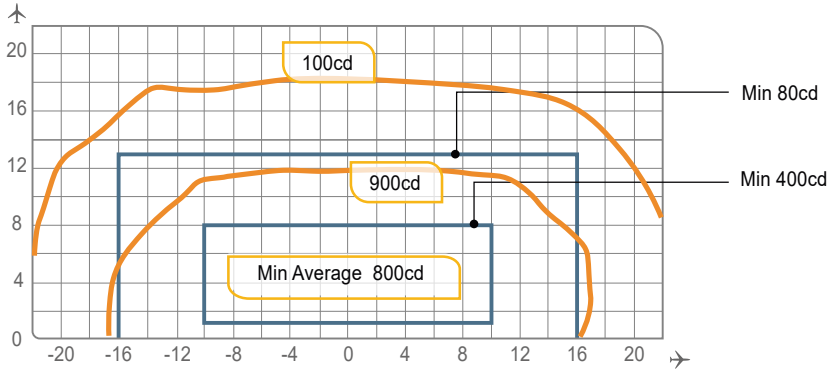


**Figure 2**  
On 12" shallow base with 12 7/8" adapter ring



**Figure 3**  
On 12" deep base with 12 7/8" adapter ring

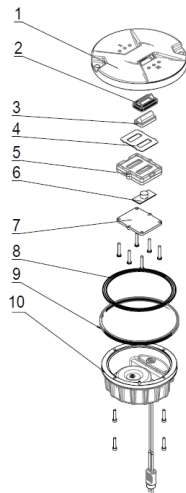
**Photometry**



TCLMS-08-S-LED, ICAO Figura A2-12, Green

| Application    |                | Main beam |         | Color  | Required min. avg. cd. | Actual avg. cd. |
|----------------|----------------|-----------|---------|--------|------------------------|-----------------|
|                |                | H         | V       |        |                        |                 |
| TCLMS-08-S-LED | ICAO Fig.A2-12 | ±10°      | 1° a 8° | Green  | 800                    | 947             |
|                |                |           |         | Yellow | 800                    | 994             |

**Structure**



- 1 Upper cover
- 2 Prism gasket sleeve
- 3 Prism
- 4 Prism gasket
- 5 Prism pressing bracket
- 6 LED lamp assy
- 7 Cooling plate
- 8 Light body gasket
- 9 Lighting fixture gasket
- 10 Inner cover assy

## Spare Parts

| N° | Order No. | Description               |
|----|-----------|---------------------------|
| 2  | 43111     | Prism gasket sleeve       |
| 3  | 31152     | Prism (toe-in left)       |
|    | 31153     | Prism (toe-in right)      |
|    | 31151     | Prism (straight)          |
| 4  | 43313     | Prism gasket              |
| 5  | 4321A     | Prism pressing bracket    |
| 6  | 979231-GG | LED lamp assy 2x1P-0 (GG) |
|    | 7922B-G   | LED lamp assy 3P-0 (G)    |
|    | 7922B-Y   | LED lamp assy 2x1P-0 (GG) |
| 8  | 41141     | Light body gasket         |
| 9  | 41107     | Light fixture gasket      |

## Accessories

| N° | Order No.   | Description                       |
|----|-------------|-----------------------------------|
| 1  | SB-08       | 8" shallow base                   |
| 2  | SB-12       | 12" shallow base                  |
| 3  | DB-12       | 12" deep base                     |
| 4  | AR-12/08    | 12"/8" adapter ring               |
| 5  | 951101      | 8" lamp handle                    |
| 6  | ITF-025-066 | 25W isolation transformer         |
| 7  | REC7        | Secondary cable connector style 7 |



## Weight and Dimensions

|                       | Base                       | 8" shallow base            |
|-----------------------|----------------------------|----------------------------|
| <b>Packaging size</b> | 210x210x130mm <sup>3</sup> | 240x240x180mm <sup>3</sup> |
| <b>Weight</b>         | 3,5 kg                     | 6,5 kg                     |