

RCLZ-08-LED

In-pavement LED runway centerline light - Airsafe



Airsafe

Contact details:



E-mail: aes@aes-europe.com



Phone Number:
+00376 665572



Compliance

- ICAO Annex. 14, Vol. I
- FAA AC 150/5345-46
- IEC-TS 61827
- EASA: CS-ADR-DSN
- STANAG 3316
- AENA PPT-013_03-12

Uses

In-pavement LED runway centerline lights for airports CAT I, II y III, according to ICAO, Figures A2-6 & A2-7.

Features

- 8" external diameter, with upper and lower cover manufactured on high strength forged aluminum, and only 6mm of profile over pavement.
- Stainless steel hardware.
- Uni-directional and bi-directional configuration.
- Surface treatment to prevent the wear and increase the corrosion resistance, which makes it especially resistant to dust and water.
- Smooth surface without sharpened edges to avoid damages at the aircraft tyres.
- No negative slope on the light channel.
- Regulation according to FAA EB67E equivalent to a halogen lamp.
- Integrated surge protection.
- Efficient control of LEDs operating temperature, increasing the light life and avoid color change.
- High features optical design.
- Compatible with existing circuits of visual aids.

Specifications

- Power: 2.8A ~ 6.6A, according to FAA EB67D.
- Average life: minimum 60.000h at maximum brightness and 100.000h in a normal operating conditions.
- Colors: Red and White.
- Consumption: 24VA (bi-direccional) - 17 VA (uni-direccional) ; PF >0,97.
- Consumption with Artic Kit on: 24VA + 14VA (CC); 17VA + 14VA (CR).
- Index Protection: IP68.

Contact details:



E-mail: aes@aes-europe.com



Phone Number:
+00376 665572



Order Code

Type	RCLZ-08-LED-XX-XX-X
RCLZ-08= 8"6mm zero water runway centerline light (6.3mm protrusion above pavement)	
Light source	LED=LED lamp
Beam color	CC=Both windows: white CR=Winow 1: white window 2: red CB=One single window: white RB=One single window: red
Plug	1P=one plug 2P=two plugs
Optional function	M=Single lamp fault detection function A=Arctic Kit

Installation

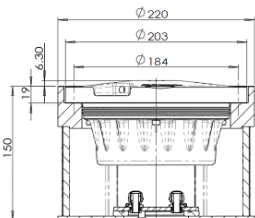

Fig 1 On 8" shallow base

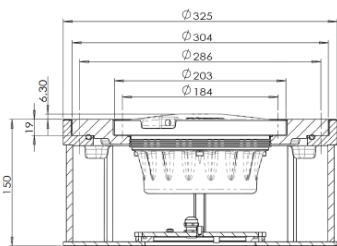

Fig 2. On 12" shallow base w/ 12"/8" adapter ring

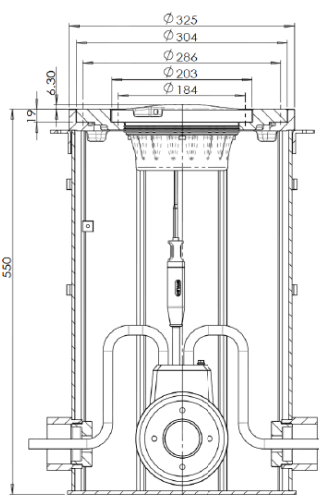
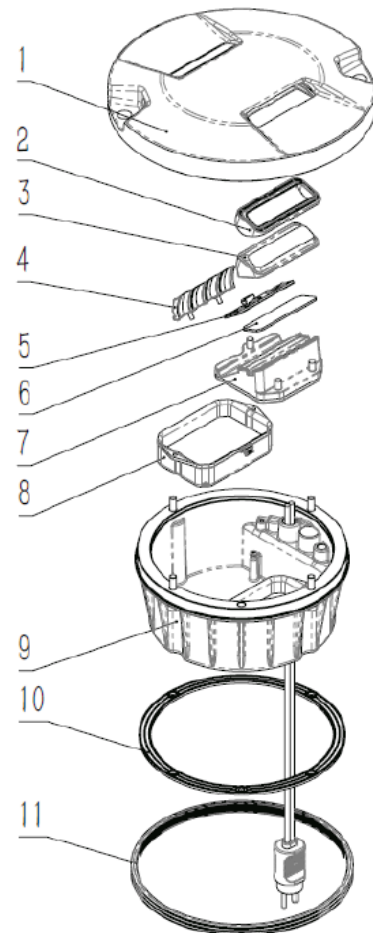

Fig 3. On 12" deep base w/ 12"/8" adapter ring

Structure



1. Upper cover
2. Prism gasket sleeve
3. Prism
4. Reflector
5. LED lamp
6. Thermostat switch (optional)
7. Prism pressing bracket
8. Driver assy
9. Inner cover assy
10. Light body gasket
11. Lighting fixture gasket





Photometry

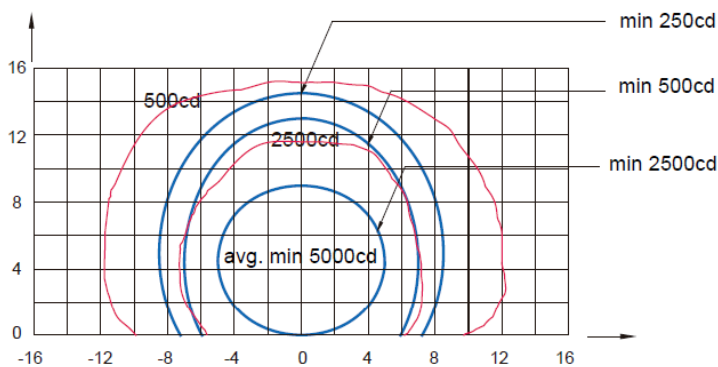

RCLZ-08-LED, ICAO Fig. A2-7, White

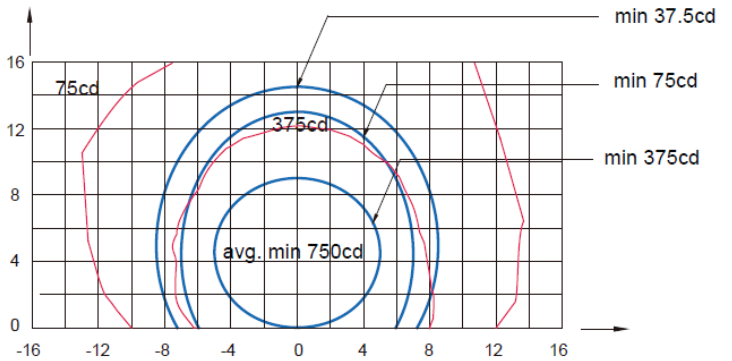

RCLZ-08-LED, ICAO Fig. A2-7, Red

Application		Main Beam		Color	Required min avg. cd	Actual avg. cd
		H	V			
RCLZ-08-LED	ICAO Figure A2-7/ FAA L-850A	$\pm 5^\circ$	0°—9°/ 0.2°—9°	White	5000	5691
				Red	750	1190
	ICAO Figure A2-6	$\pm 5^\circ$	0°—7°	White	5000	5756
				Red	750	1210

