

TOIL-08-LED

LED in-pavement taxiway and apron light - Airsafe



Airsafe

Contact details:



E-mail: aes@aes-europe.com



Phone Number:
+00376 665572



Compliance

- ICAO Annex. 14, Vol. I
- FAA AC 150/5345-46
- IEC-TS 61827
- EASA: CS-ADR-DSN
- STANAG 3316
- AENA PPT-019_03-12

Uses

LED in-pavement taxiway and apron light for airports CAT I, II & III, according to ICAO Annex 14 Part 5.3.18.8, FAA - L852T.

Features

- 8" external diameter, with upper and lower cover manufactured on high strength forged aluminum, and only 6mm of profile over pavement.
- Stainless steel hardware.
- Uni-directional and bi-directional configuration.
- Surface treatment to prevent the wear and increase the corrosion resistance, which makes it especially resistant to dust and water.
- Smooth surface without sharpened edges to avoid damages at the aircraft tyres.
- Regulation according to FAA EB67E equivalent to a halogen lamp.
- Integrated surge protection.
- Efficient control of LEDs operating temperature, increasing the light life and avoid color change.
- High features optical design.
- Compatible with existing circuits of visual aids.

Specifications

- Power: 2.8A ~ 6.6A, according to FAA EB67D.
- Average life: minimum 60.000h at maximum brightness and 100.000h in a normal operating conditions.
- Color: Yellow.
- Consumption: 20VA; FP >0,95.
- Index Protection: IP68.
- Installation for 15W isolation transformer.

Contact details:



E-mail: aes@aes-europe.com



Phone Number:
+00376 665572



Order Code

TOIL-08-L-LED-XXX-Y-X

Type _____
TOIL-08-L= low intensity 8-inch taxiway intersection light

Light Source _____
LED=LED lamp

Power Supply _____
220 = 220VAC
024 = 24VAC
012 = 12VAC
066 = 6.6A

Beam Color _____
Y = Yellow

Optional Function _____
M=single plamp fault detection function

Structure

1. Upper cover
2. Lighting fixture gasket
3. Prism
4. Prism gasket sleeve
5. Prism gasket
6. LED lamp assy
7. Prism pressing bracket
8. Light body gasket
9. Inner cover assy

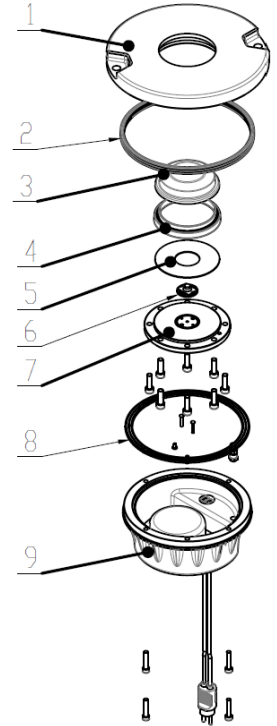

Installation

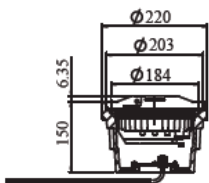

Fig 1. On 8" shallow base

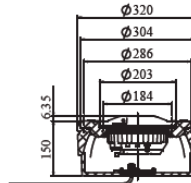

Fig 2. On 12" shallow base w/12"/8" adapter ring

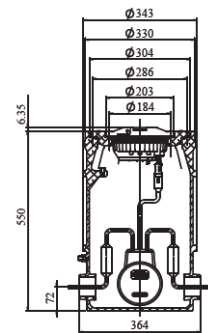

Fig 3. On 12" deep base w/ 12"/8" adapter ring

Contact details:



E-mail: aes@aes-europe.com



Phone Number:
+00376 665572



Photometry

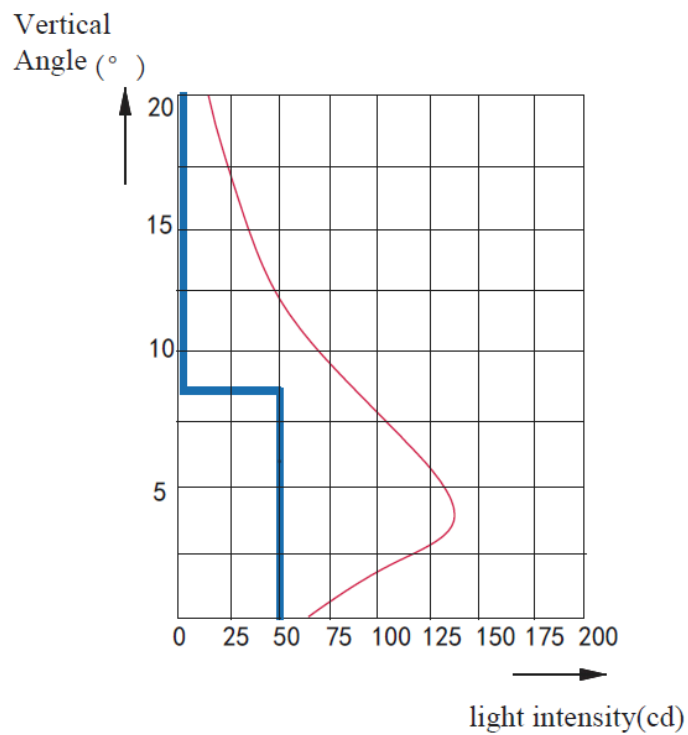

TOIL-08-L-LED, FAA L-852E, Yellow

Contact details:



E-mail: aes@aes-europe.com



Phone Number:
+00376 665572